

SCAC-N



Abb. 1

● Rechte Ausführung dargestellt

SCLC-N

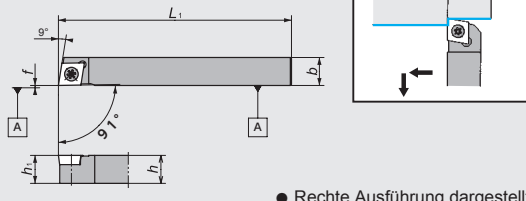

Abb. 2

● Rechte Ausführung dargestellt

SCLC-N-F

(Shifted)

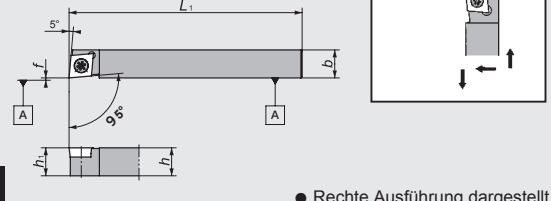

Abb. 3

● Rechte Ausführung dargestellt

SCLC

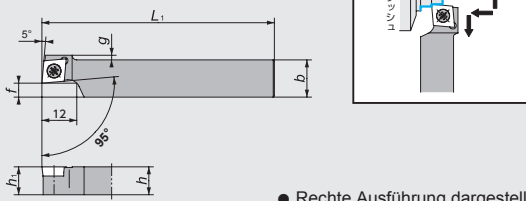

Abb. 4

● Rechte Ausführung dargestellt

SCLC-OH2

Innenkühlung

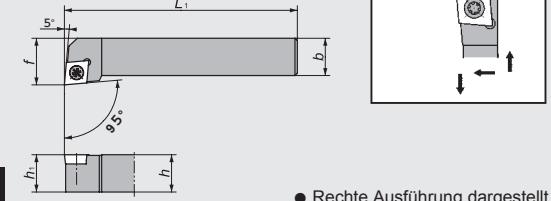

Abb. 5

● Rechte Ausführung dargestellt

SCLC-OH

Innenkühlung

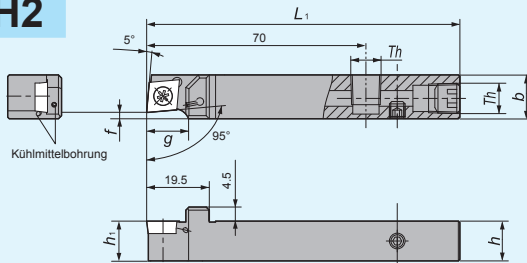

Abb. 6

● Rechte Ausführung dargestellt

DS-SCL

DS-Halter

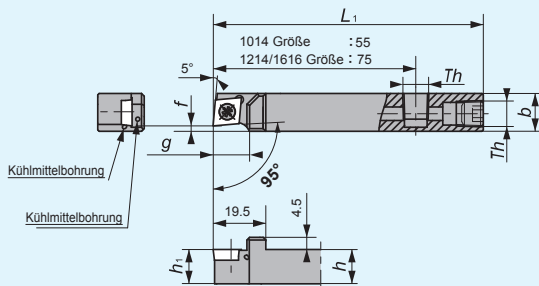

Abb. 7

● Linke Ausführung dargestellt

Hinweis: Rechte oder Neutrale WSP verwenden

DS-SCLL-ACH

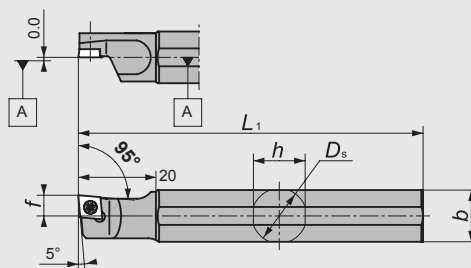
DS-Halter mit einstellbarer Spitzenhöhe

Ersatzteile		
Schaft	Keil	Keilschraube
φ16		WS060415-003 (5795539)
φ19.05	ACH-W18 (5805601)	WS060419-004 (5799226)
φ20		
φ22		
φ25	ACH-W24 (5805619)	
φ25.4		





Abb. 8

● Linke Ausführung dargestellt

Hinweis: Rechte oder Neutrale WSP verwenden

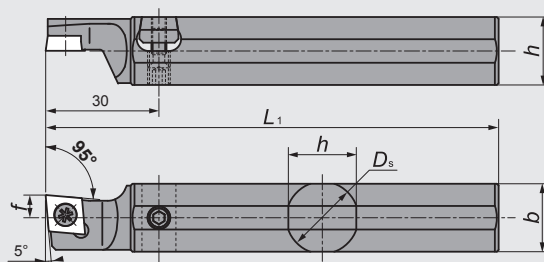
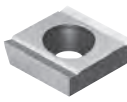
Abmessungen und Ersatzteilm Informationen

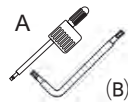
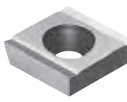
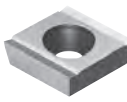
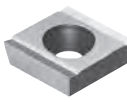
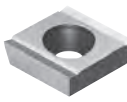
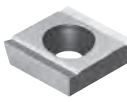
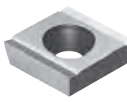
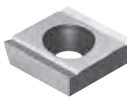
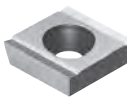
Abb.	Artikelnr.		Bezeichnung	Standard		Abmessungen (mm)						Platte	Ersatzteile			
	R	L		R	L	D _s	h	b	L ₁	h ₁	f		g		Spannschraube	Schlüssel
															A  (B)	
1	5137013	5137922	SCLC ^{R/L} 0808X06N	●	●	-	8	8	120	8	0.0	-		E28•39~40	LRIS-2.5*7	CLR-15S (A)
	5119060	5137914	1010X06N	●	●		10	10	120	10						
	5459847		1212GX09N	●			12	12	85	12						
	5137088	5137906	1212X09N	●	●		12	12	120	12						
2	5137021	5137898	SCLC ^{R/L} 0808X06N	●	●	-	8	8	120	8	0.0	-		E28•39~40	LRIS-2.5*7	CLR-15S (A)
	5122171	5137880	1010X06N	●	●		10	10	120	10						
	5873872		1010H09N	●			10	10	100	10						
	5152889	5152897	1010X09N	●	●		10	10	120	10						
	5459839	5459821	1212GX09N	●	●		12	12	85	12						
	5137039	5137872	1212X09N	●	●		12	12	120	12						
5191200	5191218	1616X09N	●	●	16	16	120	16								
3	5700240	5700257	SCLC ^{R/L} 1015X09N-F05	●		-	10	15	120	10	5	2		E28•39~40	LRIS-4*10	LLR-25S (B)
	5700265	5700273	1020X09N-F10	●			10	20	120	10	10	2				
	5700364	5700372	1218X09N-F06	●			12	18	120	12	6	0				
	5700380	5700398	1224X09N-F12	●			12	24	120	12	12	0				
4	5744719	5884911	SCLC ^{R/L} 20-X09	●	●	-	20	20	120	20	24.0	-		E28•39~40	LRIS-4*10	LLR-25S (B)
5	5037957		SCLC ^{R/L} 1214H09N-F02OH2	●		-	12	14	100	12	2	12		E28•39~40	LRIS-4*10	LLR-25S (B)
	5044011		1616X09N-F02OH2	●			16	16	120	16	2	17.7				
6	5905740		SCLC ^{R/L} 1014F09N-F02OH	●		-	10	14	80	10	2	12		E28•39~40	LRIS-4*10	LLR-25S (B)
	5905732		SCLC ^{R/L} 1214H09N-F02OH	●			12	14	100	12	2	12				
	5905658		SCLC ^{R/L} 1616H09N-F02OH	●			16	16	100	16	2	17.7				
7	5602636		DS-SCL ^{R/L} 14F-06	●		14.000	13	13	80	-	6.0	-		E28•39~40	LRIS-2.5*7	CLR-15S (A)
	5486923		15H-06	●		15.875	15	15	100							
	5601703		16F-06*	●		16.000			80							
	5338876		19-06	●		19.050	18	18	120							
	5520630		20X-06	●		20.000	19	19	95							
	5388608		20-06	●		20.000										
	5484936		22-06*	●		22.000	21	21	120							
	5520689		25-06MET	●		25.000	24	24								
	5486691		25-06	●		25.400			150							
	5601729		14F-09	●		14.000	13	13	80							
	5486931		15H-09	●		15.875	15	15	100							
	5601711		16F-09*	●		16.000			80							
	5563168		19GX-09	●		19.050	18	18	85							
	5338884		19-09	●		19.050			120							
	5520655		20X-09	●		20.000	19	19	95							
	5374699		20-09	●		20.000										
5401096		22-09*	●		22.000	21	21	120								
5520671		25-09MET	●		25.000	24	24									
5486709		25-09	●		25.400			150								
5939327		32-09	●		32.000	30	30	150								
8	5833694		DS-SCL ^{R/L} 16F-09-ACH*	●		16.00	15.5	15.5	80	-	6.0	-		E28•39~40	LRIS-4*8	LLR-25S -20*65 (B)
	5833702		19-09-ACH	●		19.05	18.0	18.0								
	5833710		20-09-ACH	●		20.00	19.0	19.0	120							
	5833728		22-09-ACH*	●		22.00	21.0	21.0								
	5934013		25-09MET-ACH	●		25.00	24.0	24.0	150							
	5833736		25-09-ACH	●		25.40	24.0	24.0	150							

※Bitte verwenden Sie bei den DS-Sleeve Haltern einen Halter DMR von 16mm / 22mm, weitere Info → G103

Außen-
bearbeitung

Y-SDJC

(Y-Achse)



Abb. 1

- ☆ Rechte oder neutrale WSP verwenden
- Rechte Ausführung dargestellt

Y-SDNC

(Y-Achse)

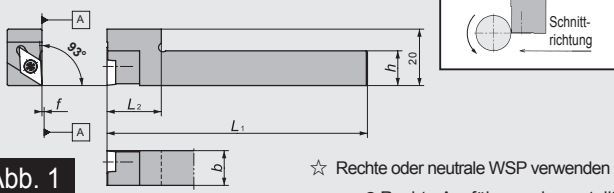

Abb. 2

Y-SDJC-OH2

(Y-Achse/
Innenkühlung)

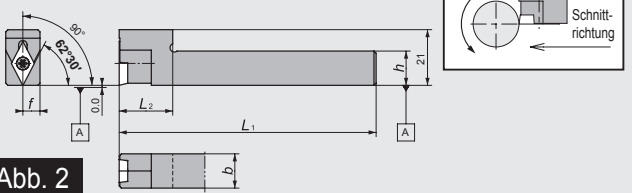

Abb. 3

- ☆ Rechte oder neutrale WSP verwenden
- Rechte Ausführung dargestellt

Y-SDJC-OH

(Y-Achse/
Innenkühlung)

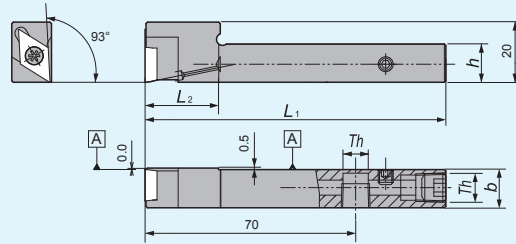

Abb. 4

- ☆ Rechte oder neutrale WSP verwenden
- Rechte Ausführung dargestellt

DS-SDU

(DS-Halter)

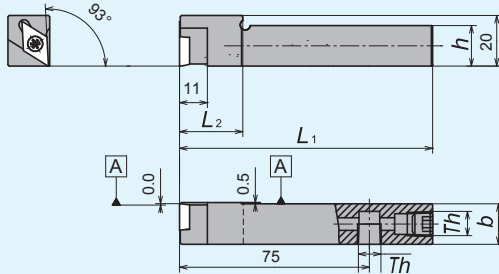

Abb. 5

- ☆ Rechte oder neutrale WSP verwenden
- Linke Ausführung dargestellt

DS-SDU-ACH

(DS-Halter mit einstellbarer Spitzenhöhe)

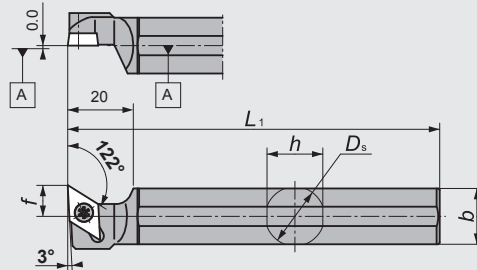
Ersatzteile

Schaft	Keil	Keilschraube
φ16	ACH-W18 (5805601)	WS060415-003 (5795539)
φ19.05		
φ20	ACH-W24 (5805619)	WS060419-004 (5799226)
φ22		
φ25		
φ25.4		



Abb. 6

- ☆ Rechte oder neutrale WSP verwenden
- Linke Ausführung dargestellt

DS-SDX

(DS-Halter)

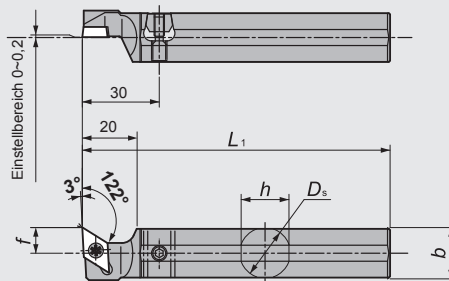

Abb. 7

- ☆ Rechte oder neutrale WSP verwenden
- Linke Ausführung dargestellt

Abmessungen und Ersatzteilinformationen

Abb.	Artikelnr.		Bezeichnung	Standard	Abmessungen (mm)						Platte	Ersatzteile		
	R	L			D _s	h	b	L ₁	f	L ₂		Spannschraube	Schlüssel	
	N	L									R			N
1	5371646		Y-SDJCR _L 10-07S	●		10.0	10					DC 0702 E29·42~43 TFD07 E44	LRIS-2.5*7	CLR-15S (A)
	5371661		12-07S	●		12.0	12							
	5926001		10-11S	●		10.0						DC 11T3 E29·42~43 TFD11 E44	LRIS-4*10	LLR-25S -20*65 (B)
	5950431		10-11MS	●	–	10.0		120	0.0	22				
	5600671		12-11S	●		12.0	16			20				
	5950423		12-11MS	●		12.0				22				
	5890025		16-11S	●		16.0				20				
2	5479191		Y-SDNCN12-11S	●	–	12.0	12		120	6.0	20	DC 11T3 E29·42~43	LRIS-4*10	LLR-25S-20*65 (B)
	5485875		N16-11S	●		16.0	16			8.0				
3	5035209		Y-SDJCR _L 1212H11S-OH2	●	–	12	12	100	–	–	20	DC 11T3 E29·42~43 TFD11 E44	LRIS-4*10	LLR-25S-20*65 (B)
4	5910575		Y-SDJCR _L 1212H11S-OH	●	–	12	12	100	–	–	20	DC 11T3 E29·42~43 TFD11 E44	LRIS-4*10	LLR-25S-20*65 (B)
	5910583		1616H11-OH	●	–	16	16			–	25			
5	5348545		DS-SDUR _L 14F-07	●	14.000	13.0	13	80			6.0	DC 0702 E29·42~43 TFD07 E44	LRIS-2.5*7	CLR-15S (A)
	5348107		15H-07	●	15.875			100						
	5520598		16F-07*	●	16.000	15.0	15	80						
	5341516		16X-07*	●				95						
	5278247		19-07	●	19.050	18.0	18	120						
	5520606		20X-07	●	20.000	19.0	19	95						
	5278239		20-07	●				120						
	5330758		22-07*	●	22.000	21.0	21							
	5601745		14F-11	●	14.000	13.0	13	80						
	5601737		16F-11*	●	16.000	15.0	15		10.0	–				
	5278262		19-11	●	19.050	18.0	18	120						
	5572730		19-11SPL	●				160	11.0					
	5520614		20X-11	●	20.000	19.0	19	95						
	5278254		20-11	●				120						
	5324025		22-11*	●	22.000	21.0	21		10.0					
	5638606		23-11-007	●	23.000	22.0	22	70						
5483417		25-11MET	●	25.000			120							
5317136		25-11	●	25.400	24.0	24		150						
5713581		25-11SPL	●	25.400				12.5						
6	5805635		DS-SDUR _L 16F-11-ACH	●	16.000	15.5	15	80			10.0	DC 11T3 E29·42~43 TFD11 E44	LRIS-4*10	LLR-25S -20*65 (B)
	5805627		19-11-ACH	●	19.050	18.0	18							
	5799614		20-11-ACH	●	20.000	19.0	19	120						
	5799622		22-11-ACH	●	22.000	21.0	21							
	5934021		25-11MET-ACH	●	25.000	24.0	24		150					
	5799648		25-11-ACH	●	25.400	24.0	24							
7	5462429		DS-SDXR _L 19-11	●	19.050	18.0	18	120			10.0	DC 11T3 E29·42~43	LRIS-4*10	LLR-25S (B)
	5520622		20X-11	●	20.000	19.0	19	95						
	5462437		20-11	●				120						
	5520697		25-11MET	●	25.000	24.0	24							
	5939335		32-11	●	32.000	30.0	30	150						

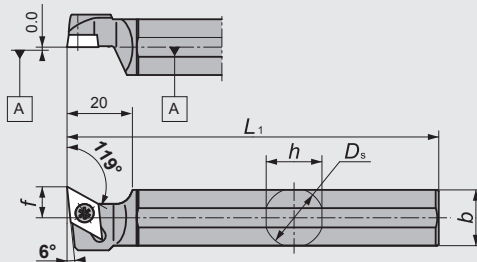
*Bitte verwenden Sie bei den DS-Sleeve Haltern einen Halter DMR von 16mm / 22mm, weitere Info → G103

SVXP-N



Abb. 1

● Rechte Ausführung dargestellt

SVQP-N

R	ap	ΦD(Min)
0.05	0.2	2.5
	0.5	4.5
0.08	0.2	2.5
	0.5	4.5
0.18	0.2	3.5
	0.5	5.5
0.2	0.2	3.5
	0.5	5.5

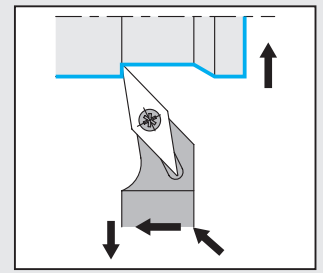
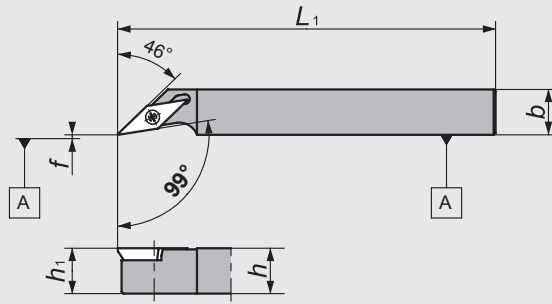

Abb. 2

● Rechte Ausführung dargestellt

CH-SVUP

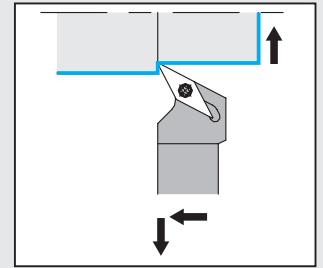
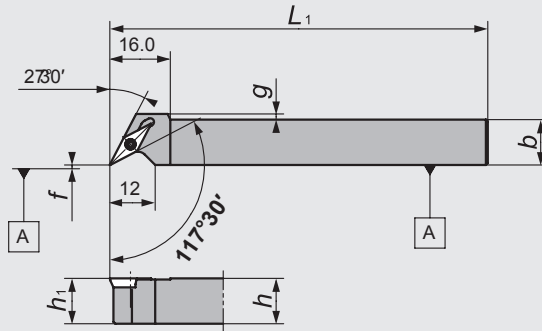
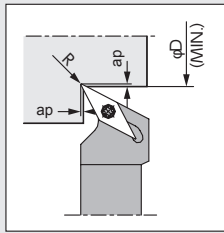

Abb. 3

☆ Rechte oder neutrale WSP verwenden
● Linke Ausführung dargestellt

DS-SVVP

(DS-Halter)

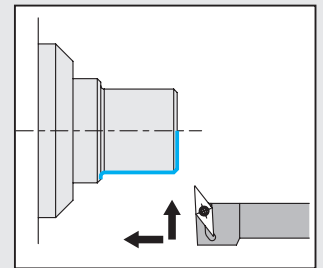
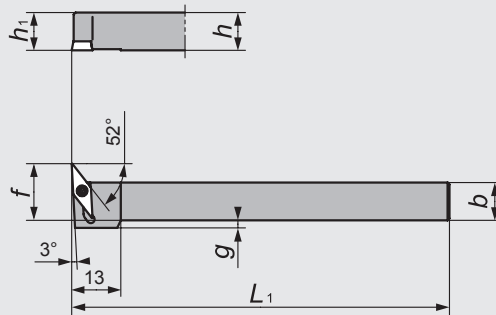

Abb. 4

DS-SVVP-ACH

DS-Halter mit einstellbarer Spitzenhöhe

Ersatzteile

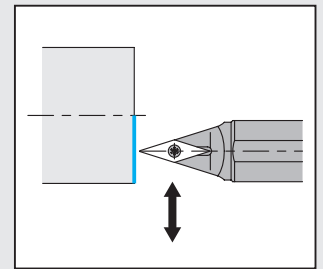
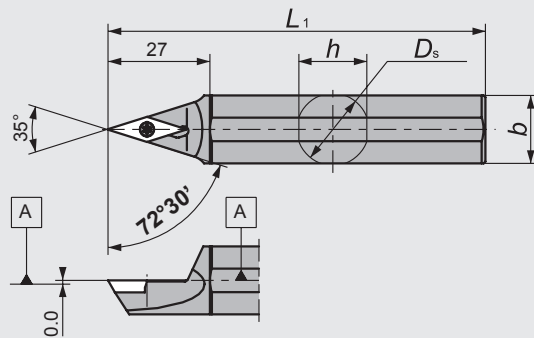
Schaft	Keil	Keilschraube
φ16		WS060415-003 (5795539)
φ19.05	ACH-W18 (5805601)	WS060419-004 (5799226)
φ20		
φ22		
φ25.4	ACH-W24 (5805619)	

Einstellbereich 0~0,2



Abb. 5

DS-SVXP

(DS-Halter)

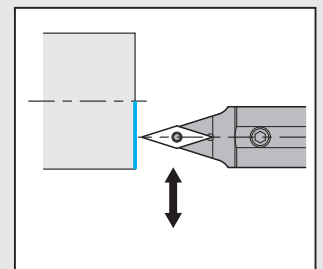
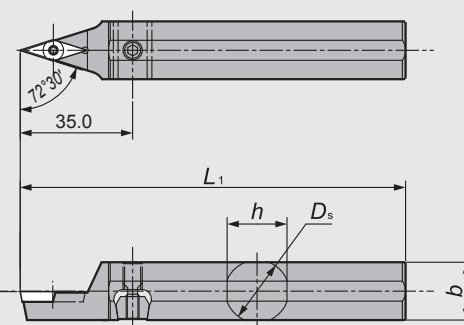

Abb. 6

☆ Rechte oder neutrale WSP verwenden
● Linke Ausführung dargestellt

Abmessungen und Ersatzteilmformationen

Abb.	Artikelnr.		Bezeichnung	Standard		Abmessungen (mm)							Platte	Ersatzteile	
	R	L		R	L	D_s	h	b	L_1	h_1	f	g		Spannschraube	Schlüssel
1	5511506	5511514	SVXP ^{R/L} 1012X11N	●	●	—	10.0	12	120	10	—	—	VP□□1103 E50	LRIS-2.5*7	CLR-15S
	5511522	5511548	1212X11N	●	●	—	12.0	12	120	12	0.0	—			
2	5600622	5600614	SVQP ^{R/L} 1010X08N	●	●	—	10.0	10	—	—	—	3.5	VP□□0802 E50	LRIS-2*6	CLR-13S
	5600598	5600606	1212X08N	●	●	—	12.0	12	120	10	0.0	1.5			
	5600580	5600564	1616X08N	●	●	—	16.0	16	—	—	—	—			
3		5659206	CH-SVUP ^{R/L} 1010H08		●	—	10.0	10	—	10	15	2	VP□□0802 E50	LRIS-2*6	CLR-13S
		5659214	1212H08		●	—	12.0	12	100	12	17	0			
4	5511555		DS-SVVPN19-11	●	—	19.050	18.0	18	—	—	—	—	VP□□1103 E50	LRIS-2.5*7	CLR-15S
	5511563		N22-11	●	—	22.00	21.0	21	120	—	—	—			
5	5805643		DS-SVVPN16-11-ACH*	●	—	16.000	15.5	15	—	—	—	—	VP□□1103 E50	LRIS-2.5*7	CLR-15S
	5799655		N19-11-ACH	●	—	19.050	18.0	18	120	—	—	—			
	5799663		N20-11-ACH	●	—	20.000	19.0	19	120	—	—	—			
	5799671		N22-11-ACH*	●	—	22.000	21.0	21	120	—	—	—			
	5807524		N25-11-ACH	●	—	25.400	24.0	24	150	—	—	—			
6		5534003	DS-SVXP ^{R/L} 19-08	●	—	19.050	18.0	18	—	—	—	—	VP□□0802 E50	LRIS-2*6	CLR-13S
		5534011	20-08	●	—	20.000	19.0	19	120	—	10	—			
		5600549	22-08*	●	—	22.000	21.0	21	—	—	—	—			
		5533997	25-08	●	—	25.400	24.0	24	150	—	—	—			

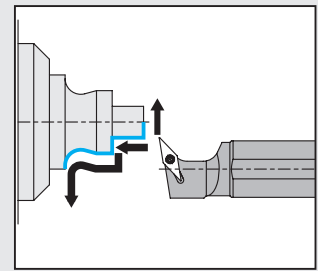
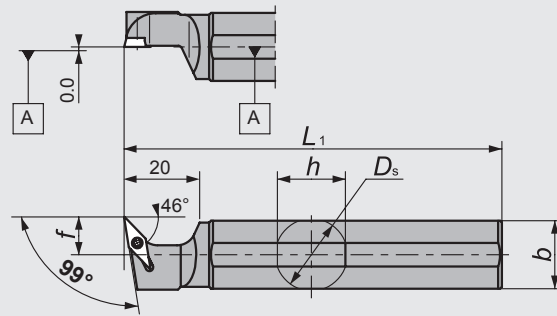
※Bitte verwenden Sie bei den DS-Sleeve Haltern einen Halter DMR von 16mm / 22mm, weitere Info → G103

PTAN-N

Kniehebelklemmung

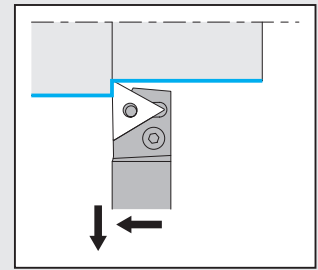
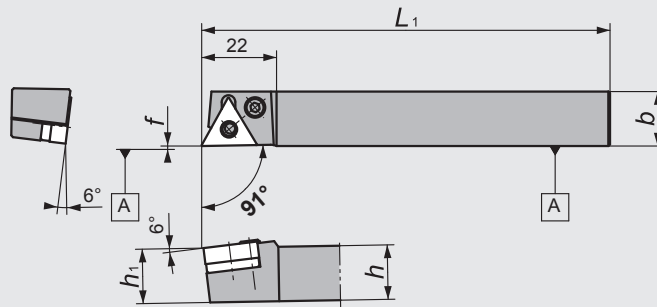

● Rechte Ausführung dargestellt

Abb. 1

PTLN

Kniehebelklemmung

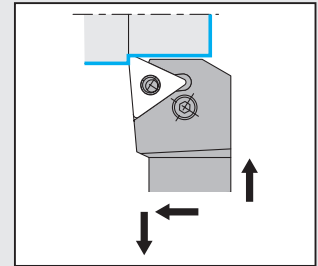
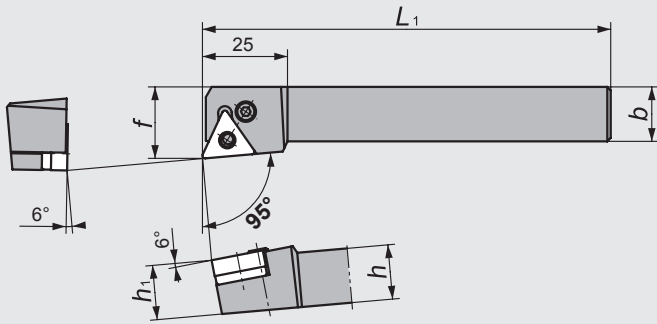

● Rechte Ausführung dargestellt

Abb. 2

PTXN-N

Kniehebelklemmung

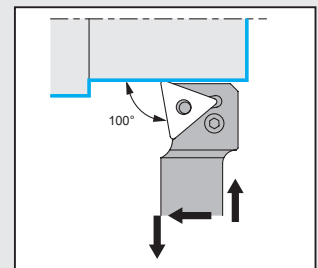
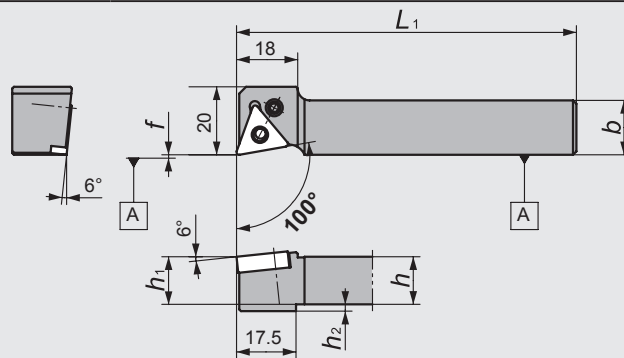

● Rechte Ausführung dargestellt

Abb. 3

DS-PTX

Kniehebelklemmung
DS-Halter

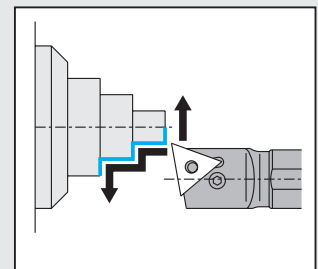
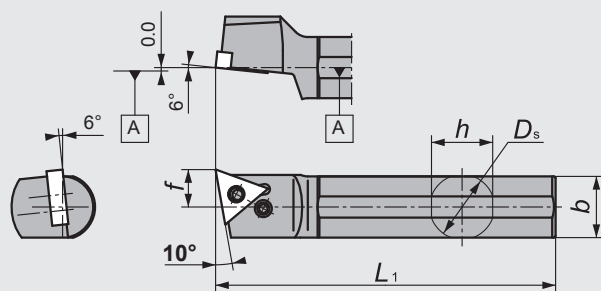

☆ Rechte oder neutrale WSP verwenden

● Linke Ausführung dargestellt

Abb. 4

DS-PTX-ACH

DS-Halter mit einstellbarer Spitzenhöhe

Ersatzteile

Schaft	Keil	Keilschraube
φ16		WS060415-003 (5795539)
φ19.05	ACH-W18 (5805601)	
φ20		WS060419-004 (5799226)
φ22		
φ25	ACH-W24 φ25.4 (5805619)	

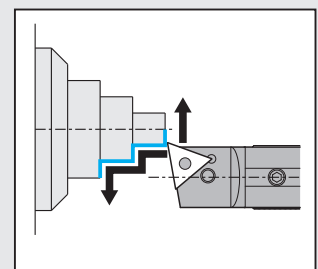
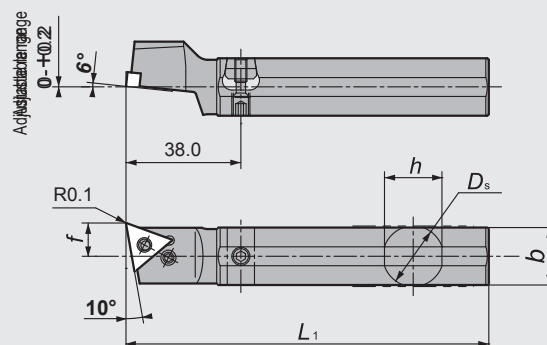

☆ Rechte oder neutrale WSP verwenden

● Linke Ausführung dargestellt

Abb. 5

STXNR-N



Abb. 6

※ nur für UL-Spanbrecher

● Rechte Ausführung dargestellt

Abmessungen und Ersatzteilinformationen

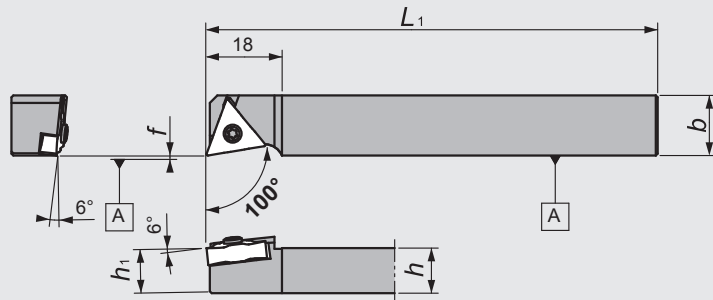
Abb.	Artikelnr.		Bezeichnung	Standard		Abmessungen (mm)						Platte	Ersatzteile					
	R	L		R	L	D_s	h	b	L_1	h_1	f		h_2	Unterlage	Hebel	Schraube	Feder	Schlüssel
1	5252325		PTAN ^{R/L} 1616X33N	●		—	16	16	120	16	0.0	—	TN ¹⁶⁰⁴ E25~26• 37	LST317	LCL3	LCS3	LSP3	LW-2.5
2	5552336	5552344	PTLN ^{R/L} 2020L33	●	●	—	20	20	140	20	25	—	TN ¹⁶⁰⁴ E25~26• 37	LST317	LCL3	LCS3	LSP3	LW-2.5
3	5479860		PTXN ^{R/L} 1016X33N	●		—	10	16	120	10	0.0	2	TN ¹⁶⁰⁴ E25~26• 37	/	/	/	/	/
	5016183		1216X33NGX	●			85		12									
	5479852		1216X33N	●			120		0									
	5489901		1616X33N	●			16		16									
	5513965		2020X33N	●			20		20									
4	5815766		DS-PTX ^{R/L} 16-33	★		16.00	15	18	120	—	11.0	—	TN ¹⁶⁰⁴ E25~26• 37	/	/	/	/	/
	5519707		19-33	●		19.05	18	18										
	5519715		20-33	●		20.00	19	19										
	5591029		22-33*	●		22.00	21	21										
	5519699		25M-33	●		25.40	24	24										
5	5805650		DS-PTX ^{R/L} 16-33-ACH*	●		16.00	15.5	15	120	—	11.0	—	TN ¹⁶⁰⁴ E25~26• 37	/	/	/	/	/
	5799689		19-33-ACH	●		19.05	18	18										
	5799697		20-33-ACH	●		20.00	19	19										
	5799705		22-33-ACH*	●		22.00	21	21										
	5934039		25-33MET-ACH	●		25.00	24	24										
	5799713		25-33-ACH	●		25.40												

Abb.	Artikelnr.		Bezeichnung	Standard		Abmessungen (mm)						Platte	Ersatzteile		
	R	L		R	L	D_s	h	b	L_1	h_1	f		h_2	Spannschraube	Schlüssel
6	5837893		STXNR1016X33N	●		—	10	16	120	10	0	—	TNGG1604□□ MFNUL E37	LR-S-3.5x10	LLR-20S
	5016191		1216X33NGX	●			85		12						
	5837901		1216X33N	●			120		16						
	5837919		1616X33N	●			16		16						

※Bitte verwenden Sie bei den DS-Sleeve Haltern einen Halter DMR von 16mm / 22mm, weitere Info → G103

Außen-
bearbeitung