

## TBP



Abb. 1

● Rechte Ausführung dargestellt

## TBP-OH2

Innenkühlung

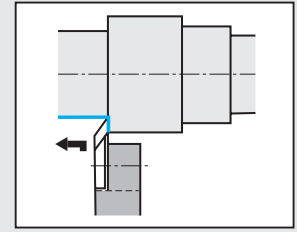
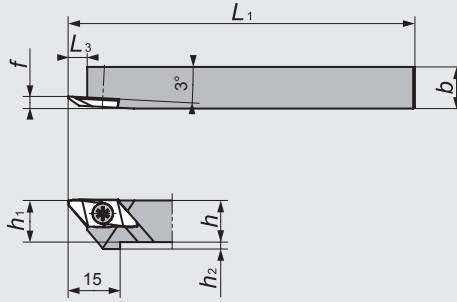

Abb. 2

● Rechte Ausführung dargestellt

## TBP-OH

Innenkühlung

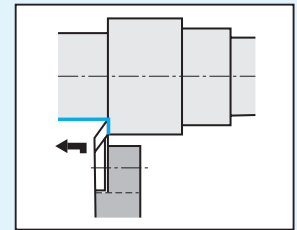
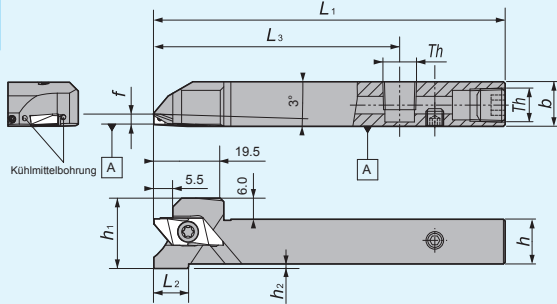

Abb. 3

● Rechte Ausführung dargestellt

## Y-TBP

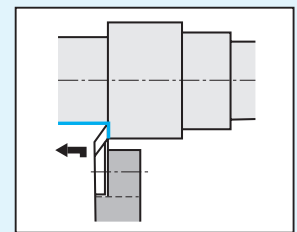
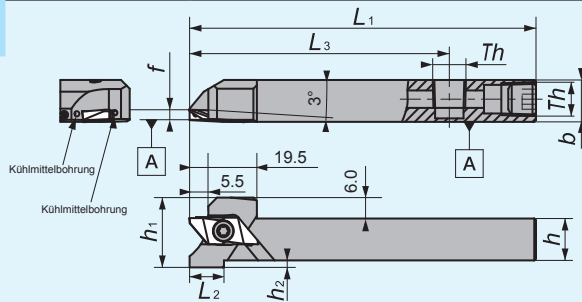

Abb. 4

☆ Rechte oder neutrale WSP verwenden

● Rechte Ausführung dargestellt

## Y-TBP-OH

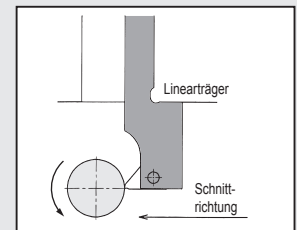
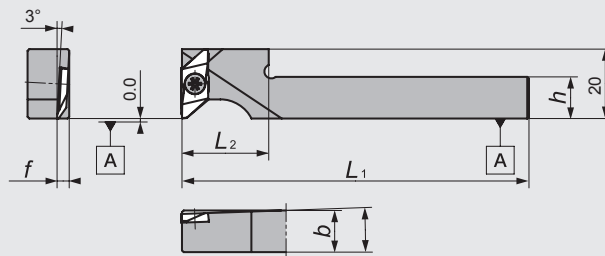
Innenkühlung



Abb. 5

☆ Rechte oder neutrale WSP verwenden

● Rechte Ausführung dargestellt

## DS-TBP

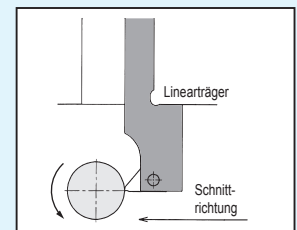
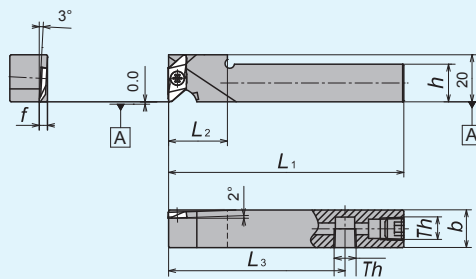
DS-Halter



Abb. 6

☆ Rechte oder neutrale WSP verwenden

● Linke Ausführung dargestellt

## Abmessungen und Ersatzteilinformationen

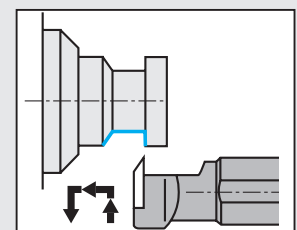
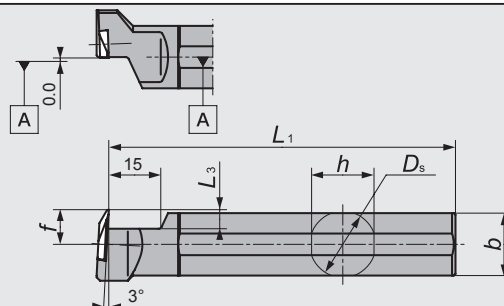
Abb.	Artikelnr.		Bezeichnung	Standard		Abmessungen (mm)								Platte	Ersatzteile						
	R	L		R	L	$D_s$	$h$	$b$	$L_1$	$h_1$	$h_2$	$f$	$L_2$		$L_3$	Spannschraube		Schlüssel			
																(A)	(B)	(A)	(B)		
1	5133285	5133293	TBP $\frac{R}{L}$ 08	●	●	-	8	10	120	8	4	3.5	-	5.5	TBP						
	5873856		10H	●	●		10	10	100	10	2										
	5090436	5090444	10	●	●		12	12	85	12	0										
	5459771		12GX	●	●		13	13	120	13	0										
	5090451	5090469	12	●	●		16	16	100	16	0										
	5090477	5090485	13	●	●		16	16	120	16	0										
	5459789		16H	●	●																
5270822	5270830	16	●	●																	
2	5037965		TBPR $\frac{R}{L}$ 12H-OH2	●	●	-	12	12	100	12	2	3.5	10	70	TBP						
	5043971		16X-OH2	●	●		16	16	120	16	0										
3	5925722		TBP $\frac{R}{L}$ 101 2H-OH	●	●	-	10	12	100	10	4	3.5	10	75	TBP						
	5925730		12H-OH	●	●		12	12		12	2										
	5925748		16H-OH	●	●		16	16		16	0										
4	5371554		Y-TBP $\frac{R}{L}$ 10S	●	●	-	10	10	120	-	-	3.5	20	-	TBP						
	5950399		10MS	●	●		10	10												22	0
	5371588		12S	●	●		12	12												20	0
	5950407		12MS	●	●		12	12												22	0
5	5911508		Y-TBP $\frac{R}{L}$ 12HS-OH	●	●	-	12	12	100	-	-	3.5	20	-	TBP						
	5911516		16H-OH	●	●		16	16												25	0
6		5540414	DS-TBP $\frac{R}{L}$ 19	●	●	19.050	18	18	120	-	-	10.0	-	5.5	TBP						
		5540422	20	●	●	20.000	19	19													
		5540430	25	●	●	25.400	24	24												150	

## Wendeschneidplatten

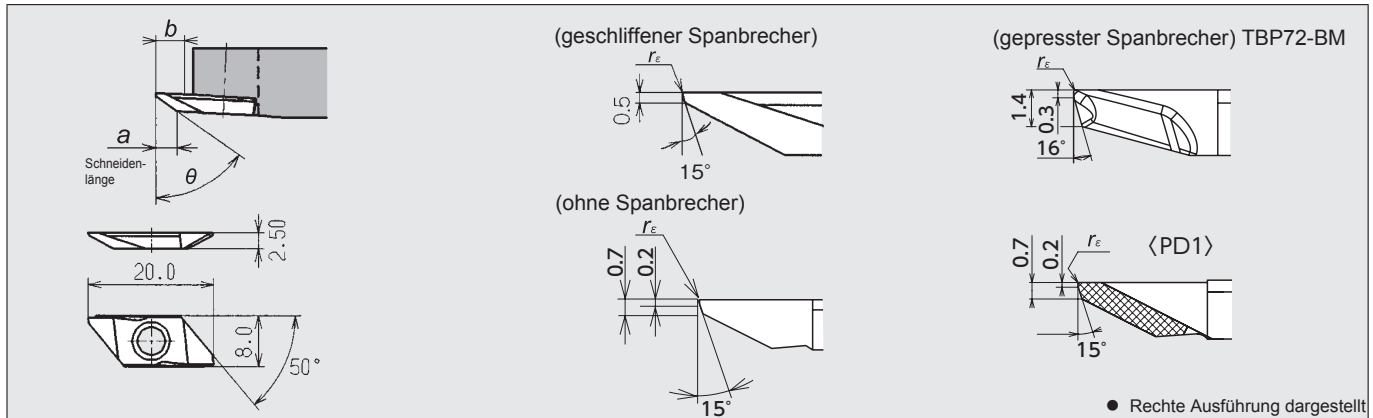

Bezeichnung	Spanbrecher	Schneidenlänge a	Max. Stechtiefe b	$\theta$	Abmessungen (mm)		PVD-Beschichtetes Hartmetall												Hartmetall		PKD						
					$r_e$		ST4		ZM3		QM3		VM1		TM4		DT4		DM4		KM1		PD1				
							R	Standard	R	Standard	L	Standard	R	Standard	R	Standard	L	Standard	R	Standard	R	Standard	R	Standard	R	Standard	
TBP72FR05-BM 72FR10M-BM 72FR20M-BM	Ja	3.5	5.3	72°	0.05	5039524	●									5868310	●		5868401	●							
					0.08	5039532	●											5868351	●		5868419	●					
					0.18	5039540	●											5868336	●		5868393	●					
TBP55F $\frac{R}{L}$ 00 55F $\frac{R}{L}$ 10	Ja	3.0	5.3	55°	0.00		●	5090378	●	5090360	●				5270855	●											
					0.10		●	5090352	●	5090386	●			5294301	●												
					0.00		●	5090410	●	5090428	●	5494711	●	5273508	●			5710108	●	5850805	●						
TBP60F $\frac{R}{L}$ 00 60F $\frac{R}{L}$ 05 60F $\frac{R}{L}$ 10 60F $\frac{R}{L}$ 10M 60F $\frac{R}{L}$ 20 60F $\frac{R}{L}$ V	Ja	3.7	5.3	60°	0.00		●	5090402	●	5090394	●	5362488	●	5269949	●			5706114	●								
					0.05		●																				
					0.10		●						5486964	●	5476403	●					5850813	●					
60F $\frac{R}{L}$ 10M 60F $\frac{R}{L}$ 20 60F $\frac{R}{L}$ V	Ja	4.8	5.3	60°	0.2		●											5738844	●								
					0.00		●	5345715	●					5264940	●	5264957	●							5299276	●		
					0.00		●																				5781745 (1 Ecke)
60FRV00-P 60F $\frac{R}{L}$ V05 60F $\frac{R}{L}$ V10 60FRV10-P	Nein	4.0	5.3	60°	0.05		●							5440680	●									5575675	●		
					0.10		●	5482690	●					5440698	●											5575683	●
					0.10		●																				

※ Wendeschneidplatten mit der Radius-Angabe "10M" können zur Herstellung von 0,1mm Radien verwendet werden.  
 ※ PD1 Wendeschneidplatten sind nur mit einer Schneidecke bestückt.

Hinterdreh-  
bearbeitung

## CTPA



Abb. 1

● Rechte Ausführung dargestellt

## TBPA-OH

Innenkühlung

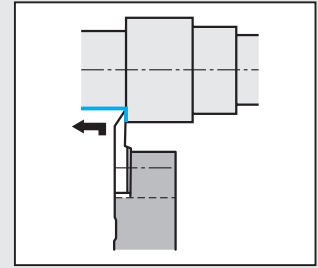
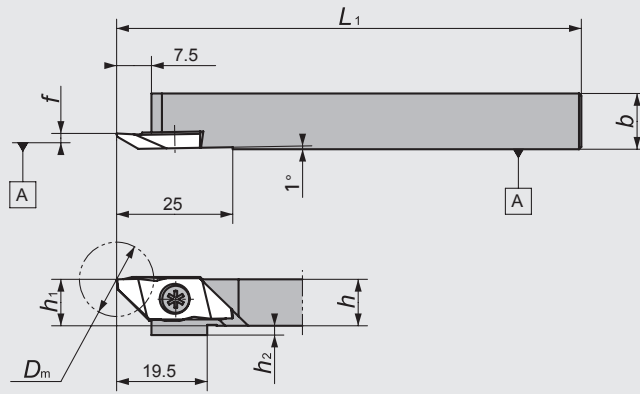

Abb. 2

● Rechte Ausführung dargestellt

## CH-TBPA

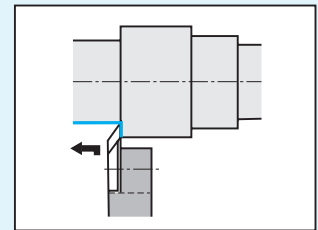
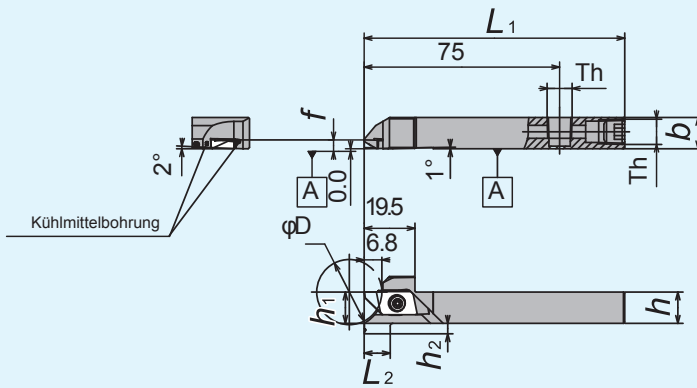

Abb. 3

☆ Rechte oder neutrale WSP verwenden

● Linke Ausführung dargestellt

## Abmessungen und Ersatzteilinformationen

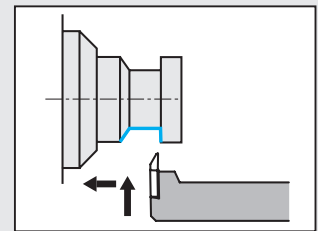
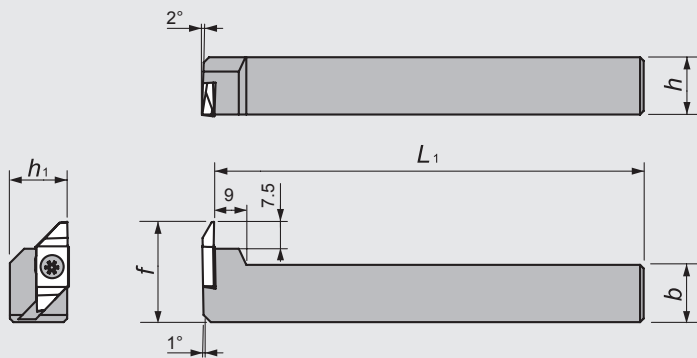
Abb.	Artikelnr.		Bezeichnung	Standard		Abmessungen (mm)							Platte	Ersatzteile				
	R	L		R	L	h	b	L <sub>1</sub>	h <sub>1</sub>	f	h <sub>2</sub>	D <sub>m</sub>		Spannschraube		Schlüssel		
														(A)	(B)	(A)		
1	5199187	5199153	CTPA <sup>R</sup> /L 10	●	●	10	10		10									
	5199195	5199161	12	●	●	12	12	120	12									
	5199203	5199179	16	●	●	16	16		16									
	5459540	5459557	20F	●	●	20	20	80	20									

Abb.	Artikelnr.	Bezeichnung	Standard	Max. Durchmesser φD (mm)	Abmessungen (mm)							Platte	Ersatzteile	
					h	b	L <sub>1</sub>	h <sub>1</sub>	f	L <sub>2</sub>	h <sub>2</sub>		Spannschraube	Schlüssel
2	5932983	TBPAR12H-OH	●	25	12	12		12						
	5932991	16H-OH	●	35	16	16	100	16	3.4	10	4	TBPA (Hinterdrehen)	LRIS-4*12PW	CLR-15S
	5945811	20H-OH	●	50	20	20		20		0	0			

Abb.	Artikelnr.		Bezeichnung	Standard		Abmessungen (mm)					Platte	Ersatzteile	
	R	L		R	L	h	b	L <sub>1</sub>	h <sub>1</sub>	f		Spannschraube	Schlüssel
3	5884945	5884952	CH-TBPA <sup>R</sup> /L 16	●	●	16	16	120	16	28	TBPA (Hinterdrehen)	LRIS-4*10	LLR-25S
			20	●	●	20	20		20	32			

## Wendeschneidplatten

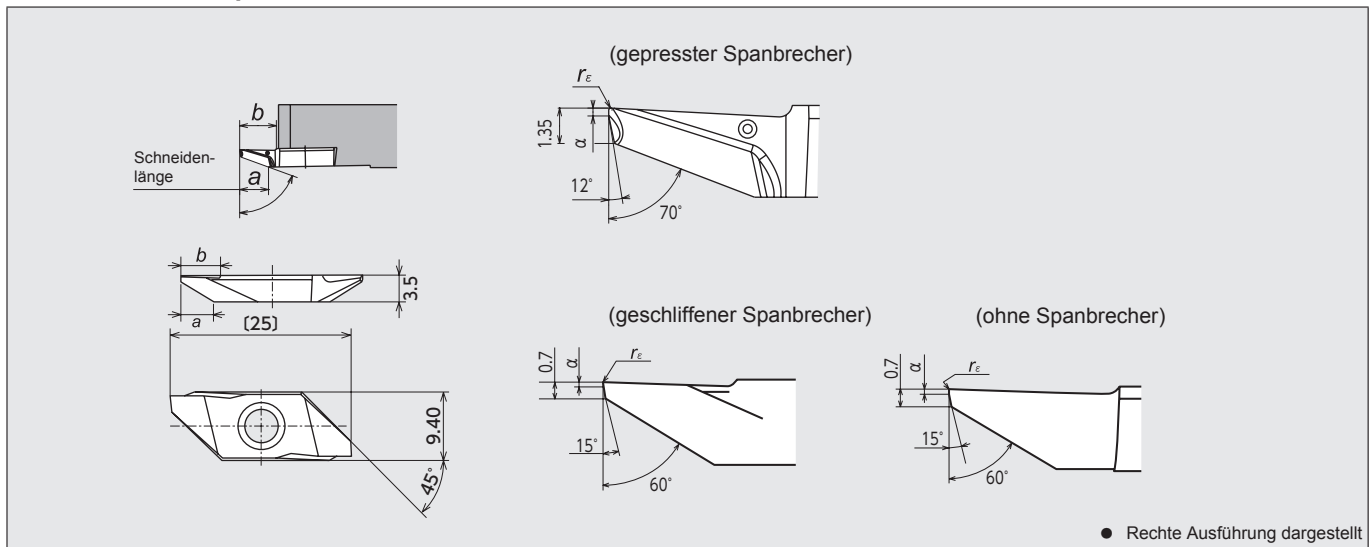

Bezeichnung	Spanbrecher	Schneidenlänge a	Max. Stechtiefe b	Abmessungen (mm)		PVD-Beschichtetes Hartmetall																		
				α	r <sub>e</sub>	ST4		ZM3		QM3		VM1		TM4		DT4		DM4						
						R	Standard	R	Standard	L	Standard	R	Standard	R	Standard	R	Standard	R	Standard	R	Standard			
<b>TBPA70FR05-BM</b>	Ja	5.5	6.5	0.05	5039557	●											5892583	●		5892591	●			
<b>70FR10M-BM</b>				0.08	5039565	●													5892567	●		5892575	●	
<b>70FR20M-BM</b>				0.18	5039573	●														5892542	●		5892559	●
<b>TBPA60F<sup>R</sup>/L VB</b>		0.2	0.0		5344833	●	5362538	●				5439344	●					5850847	●					
<b>60F<sup>R</sup>/L PB10</b>		0.1			5344858	●	5362520	●				5379151	●											
<b>60F<sup>R</sup>/L 10M</b>		0.3	*0.08											5486956	●									
<b>60F<sup>R</sup>/L PB10M</b>																				5476395	●		5850821	●
<b>60F<sup>R</sup>/L PB20M</b>																							5850839	●
<b>60F<sup>R</sup>/L V</b>	Nein	6.3	6.8	0.2	0.0																			

Hinterdreh-  
bearbeitung