

Y-SDJC

(Y-Achse)



Abb. 1

- ☆ Rechte oder neutrale WSP verwenden
- Rechte Ausführung dargestellt

Y-SDNC

(Y-Achse)

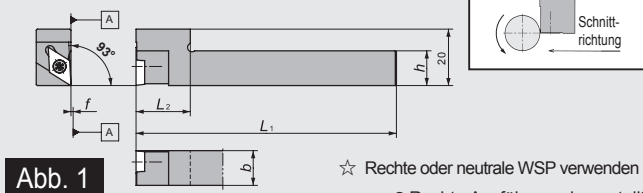

Abb. 2

Y-SDJC-OH2

(Y-Achse/
Innenkühlung)

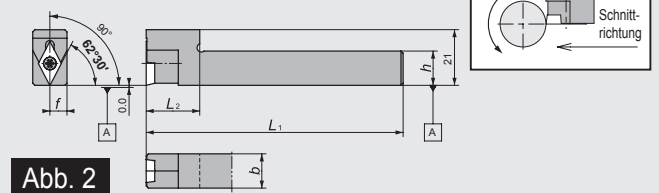

Abb. 3

- ☆ Rechte oder neutrale WSP verwenden
- Rechte Ausführung dargestellt

Y-SDJC-OH

(Y-Achse/
Innenkühlung)

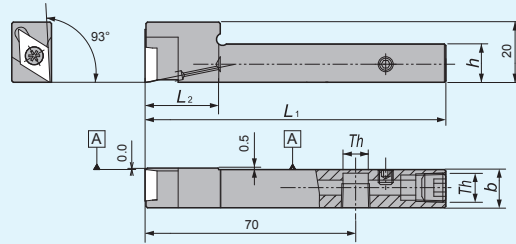

Abb. 4

- ☆ Rechte oder neutrale WSP verwenden
- Rechte Ausführung dargestellt

DS-SDU

(DS-Halter)

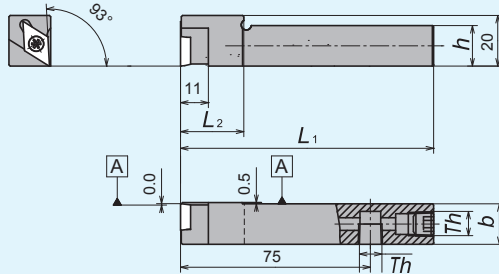

Abb. 5

- ☆ Rechte oder neutrale WSP verwenden
- Linke Ausführung dargestellt

DS-SDU-ACH

(DS-Halter mit einstellbarer Spitzenhöhe)

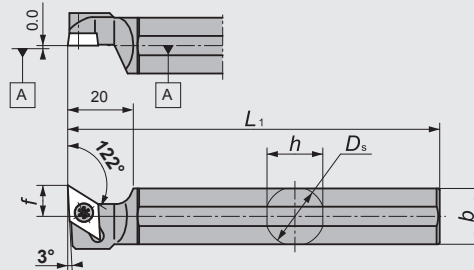
Ersatzteile

Schaft	Keil	Keilschraube
φ16	ACH-W18 (5805601)	WS060415-003 (5795539)
φ19.05		
φ20	ACH-W24 (5805619)	WS060419-004 (5799226)
φ22		
φ25		
φ25.4		



Abb. 6

- ☆ Rechte oder neutrale WSP verwenden
- Linke Ausführung dargestellt

DS-SDX

(DS-Halter)

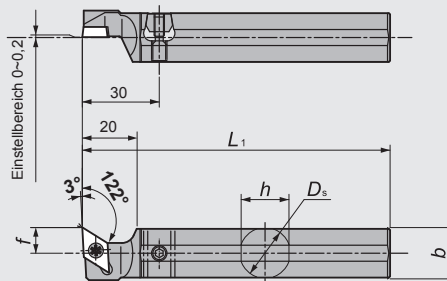

Abb. 7

- ☆ Rechte oder neutrale WSP verwenden
- Linke Ausführung dargestellt

Abmessungen und Ersatzteilinformationen

Abb.	Artikelnr.		Bezeichnung	Standard	Abmessungen (mm)						Platte	Ersatzteile			
	R	L			D _s	h	b	L ₁	f	L ₂		Spannschraube	Schlüssel		
	N	L									R			N	L
1	5371646		Y-SDJC ^R _L 10-07S	●		10.0	10					DC 0702 E29-42~43 TFD07 E44	LRIS-2.5*7	CLR-15S (A)	
	5371661		12-07S	●		12.0	12								
	5926001		10-11S	●		10.0						DC 11T3 E29-42~43 TFD11 E44	LRIS-4*10	LLR-25S -20*65 (B)	
	5950431		10-11MS	●	–	10.0		120	0.0		22				
	5600671		12-11S	●		12.0	16				20				
	5950423		12-11MS	●		12.0					22				
	5890025		16-11S	●		16.0					20				
2	5479191		Y-SDNCN12-11S	●	–	12.0	12			120	6.0	DC 11T3 E29-42~43	LRIS-4*10	LLR-25S-20*65 (B)	
	5485875		N16-11S	●		16.0	16				8.0				
3	5035209		Y-SDJC ^R _L 1212H11S-OH2	●		–	12	12	100	–	20	DC 11T3 E29-42~43 TFD11 E44	LRIS-4*10	LLR-25S-20*65 (B)	
4	5910575		Y-SDJC ^R _L 1212H11S-OH	●		–	12	12	100	–	20	DC 11T3 E29-42~43 TFD11 E44	LRIS-4*10	LLR-25S-20*65 (B)	
	5910583		1616H11-OH	●		–	16	16			25				
5	5348545		DS-SDU ^R _L 14F-07	●	14.000	13.0	13	80			6.0	DC 0702 E29-42~43 TFD07 E44	LRIS-2.5*7	CLR-15S (A)	
	5348107		15H-07	●	15.875			100							
	5520598		16F-07*	●	16.000	15.0	15	80							
	5341516		16X-07*	●				95							
	5278247		19-07	●	19.050	18.0	18	120							
	5520606		20X-07	●	20.000	19.0	19	95							
	5278239		20-07	●				120							
	5330758		22-07*	●	22.000	21.0	21								
	5601745		14F-11	●	14.000	13.0	13	80			10.0	–	DC 11T3 E29-42~43 TFD11 E44	LRIS-4*10	LLR-25S -20*65 (B)
	5601737		16F-11*	●	16.000	15.0	15								
	5278262		19-11	●	19.050	18.0	18	120							
	5572730		19-11SPL	●				160	11.0						
	5520614		20X-11	●	20.000	19.0	19	95							
	5278254		20-11	●				120							
	5324025		22-11*	●	22.000	21.0	21				10.0	–	DC 11T3 E29-42~43 TFD11 E44	LRIS-4*10	LLR-25S -20*65 (B)
	5638606		23-11-007	●	23.000	22.0	22	70							
	5483417		25-11MET	●	25.000			120							
5317136		25-11	●	25.400	24.0	24				12.5	–	DC 11T3 E29-42~43 TFD11 E44	LRIS-4*10	LLR-25S -20*65 (B)	
5713581		25-11SPL	●	25.400			150								
6	5805635		DS-SDU ^R _L 16F-11-ACH	●	16.000	15.5	15	80			10.0	–	DC 11T3 E29-42~43 TFD11 E44	LRIS-4*10	LLR-25S -20*65 (B)
	5805627		19-11-ACH	●	19.050	18.0	18								
	5799614		20-11-ACH	●	20.000	19.0	19	120							
	5799622		22-11-ACH	●	22.000	21.0	21								
	5934021		25-11MET-ACH	●	25.000	24.0	24								
	5799648		25-11-ACH	●	25.400	24.0	24	150							
7	5462429		DS-SDX ^R _L 19-11	●	19.050	18.0	18	120			10.0	–	DC 11T3 E29-42~43	LRIS-4*10	LLR-25S (B)
	5520622		20X-11	●	20.000	19.0	19	95							
	5462437		20-11	●				120							
	5520697		25-11MET	●	25.000	24.0	24								
	5939335		32-11	●	32.000	30.0	30	150							

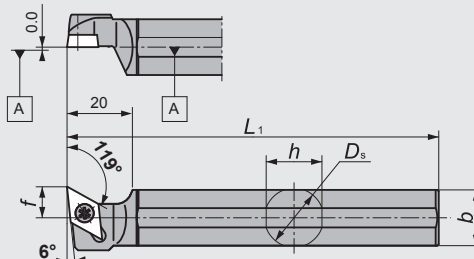
*Bitte verwenden Sie bei den DS-Sleeve Haltern einen Halter DMR von 16mm / 22mm, weitere Info → G103

SVJC-N-OH

(Innenkühlung)

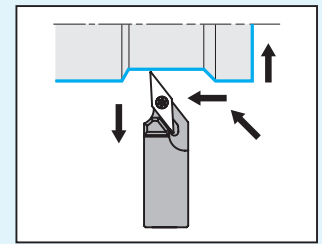
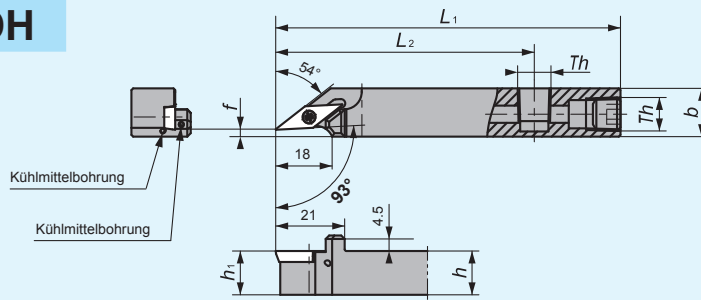

● Rechte Ausführung dargestellt

Abb. 7

Y-SVJC-OH

(Y-Achse/
Innenkühlung)

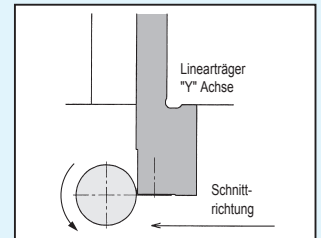
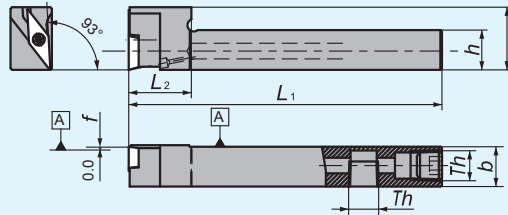

☆ Rechte oder neutrale WSP verwenden

● Rechte Ausführung dargestellt

Abb. 8

Abmessungen und Ersatzteilm Informationen

Abb.	Artikelnr.		Bezeichnung	Standard		Abmessungen (mm)						Platte	Ersatzteile		
	R	L		R	L	h	b	L ₁	h ₁	f	L ₂		g	Spannschraube	Schlüssel
1	5304043	5304092	SVAC _{R/L} 1010X11N	●	●	10	10	120	10	0.0	-	-	VC _{□□} 1103 E35•49~50	LRIS-2.5*7	CLR-15S (A)
	5304050	5304076	1212X11N	●	●	12	12		12						
	5304068		1616X11N	●		16	16		16						
2	5473053	5473038	SVAC _{R/L} 1010X11N-1L	●	●	10	10	120	10	0.0	-	-	VCGT1102 E50	LRIS-2.5*7	CLR-15S (A)
	5473061	5473046	1212X11N-1L	●	●	12	12		12						
3	5401724	5401708	SVAC _{R/L} 1010L13NW	●	●	10	10	140	10	0.0	25	-	VCGT1303 E49	LRIS-3*8	RLR-20S (B)
	5401732	5401716	1212L13NW	●	●	12	12		12						
	5401740	5431077	1616M13NW	●	●	16	16		16						
4	5744768		SVAC _{R/L} 20-X11	●		20	20	120	20	25.0	30	-	VC _{□□} 1103 E35•49~50	LRIS-2.5*7	CLR-15S (A)
5	5474549		SVAC _{R/L} 2020M13W	●		20	20	150	20	25.0	30	-	VCGT1303 E49	LRIS-3*8	RLR-20S (B)
6	5878012		SVJCR 0808H11N	●		8	8	100	8	0	19	2	VC _{□□} 1103 E35•49~50 TFV E51	LRIS-2.5*7	CLR-15S (A)
	5339940	5517750	SVJC _{R/L} 1010X11N	●	●	10	10	120	10	0.0	-	-			
	5339932	5517768	1212X11N	●	●	12	12		12						
	5339924	5517743	1616X11N	●	●	16	16		16						
7	5020482		SVJC _{R/L} 1014F11N-F02OH	●		10	14		100				80	2.0	55
	5000419		1214H11N-F02OH	●		12	14	12							
	5020508		1616H11N-F02OH	●		16	16	16							
8	5021209		Y-SVJC _{R/L} 1212H11S-OH	●		12	12	100	-	0	20	-	VC _{□□} 1103 E35•49~50 TFV E51	LRIS-2.5*7	CLR-15S (A)
	5021191		1616H11S-OH	●		16	16		-						

SVXC-N



Abb. 1



● Rechte Ausführung dargestellt

Y-SVXCL

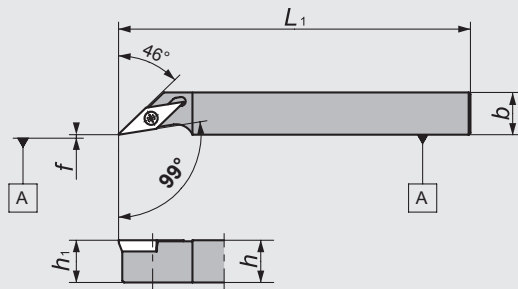
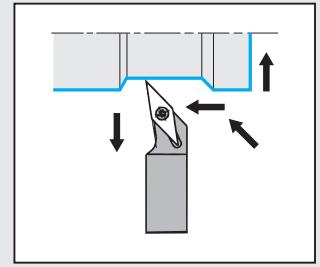
(Y-Achse)



Abb. 2



☆ Linke oder neutrale WSP verwenden
● Linke Ausführung dargestellt

SVQC

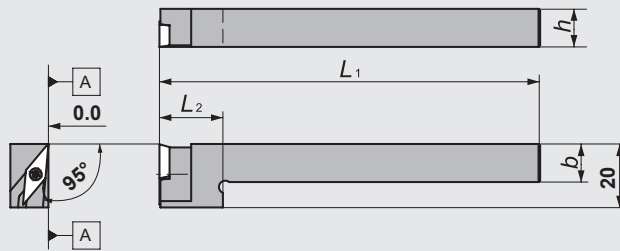
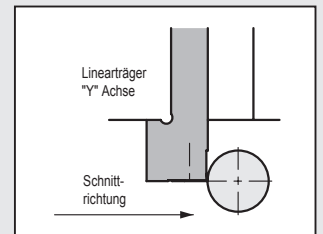

Abb. 3



● Rechte Ausführung dargestellt

SVVC-N

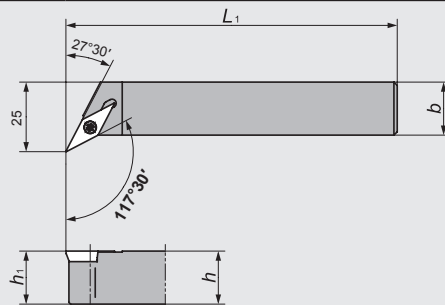
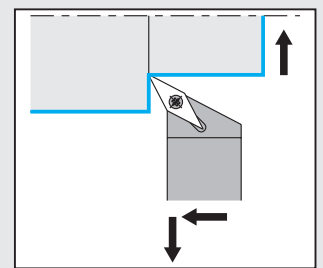

Abb. 4



● Rechte Ausführung dargestellt

SVVC-N

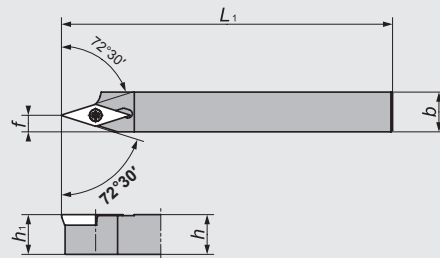
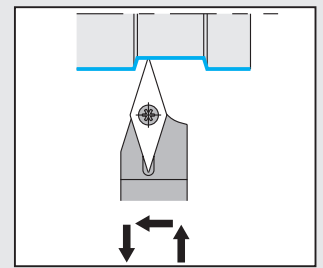

Abb. 5



DS-SVX

(DS-Halter)

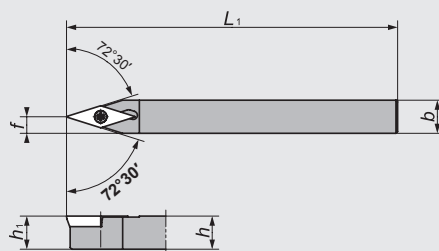
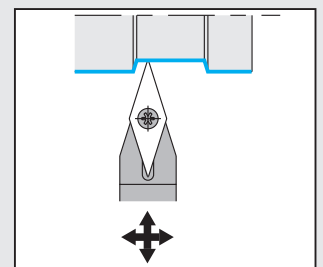

Abb. 6



☆ Rechte oder neutrale WSP verwenden
● Linke Ausführung dargestellt

CH-SVUC

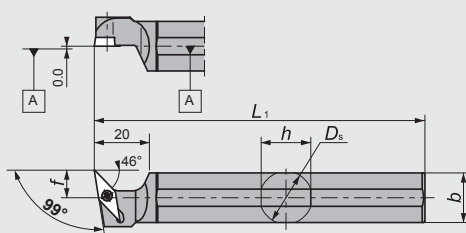
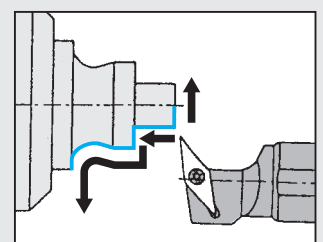



Abb. 7

☆ Rechte oder neutrale WSP verwenden
● Linke Ausführung dargestellt

Abmessungen und Ersatzteilm Informationen

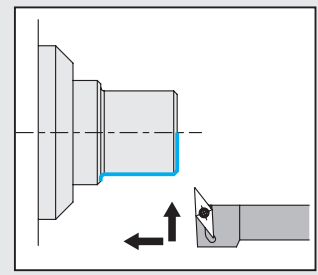
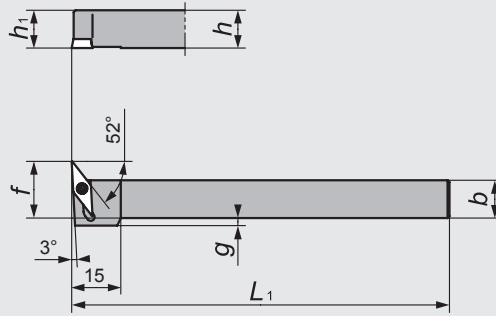
Abb.	Artikelnr.		Bezeichnung	Standard		Abmessungen (mm)								Platte	Ersatzteile		
	R	L		R	L	D_s	h	b	L_1	h_1	f	L_2	g				
																	N
1	5393731	5415815	SVXC ^{R/L} 1012X11N	●	●	—	10	12	120	10	0.0	—	—	VC□□1103 E35•49~50	LRIS-2.5*7	CLR-15S	
	5393749		1212X11N	●		—	12	12	120	12	—	—	—				
2		5917182	Y-SVXCL12-11S	●		—	12	12	120	—	—	20	—	VC□□1103 E35•49~50	LRIS-2.5*7	CLR-15S	
3	5744776		SVQC ^{R/L} 20-X11	●		—	20	20	120	20	—	—	—	VC□□1103 E35•49~50	LRIS-2.5*7	CLR-15S	
4	5523238		SVVC ^{R/L} 1212X11N	●		—	12	12	120	12	5	—	—		LRIS-2.5*7	CLR-15S	
	5523212		1616X11N	●		—	16	16	120	16	—	—	—		LRIS-2.5*7	CLR-15S	
5	5877998		SVVCN0808H11N	●		—	8	8	100	8	4	—	—		LRIS-2.5*7	CLR-15S	
	5461835		SVVCN1010X11N	●		—	10	10	120	10	5	—	—				
	5744792		N20-X11	●		—	20	20	120	20	10	—	—				
6	5601778		DS-SVX ^{R/L} 14F-11	●		14.000	13	13	80	10.0	—	—	—		VC□□1103 E35•49~50	LRIS-2.5*7	CLR-15S
	5418413		15H-11	●	15.875	15	15	100									
	5601752		16F-11*	●	16.000			80									
	5393756		19-11	●	19.050	18	18	120									
	5572722		19-11SPL	●				160	11.0								
	5520663		20X-11	●	20.000	19	19	95									
	5393764		20-11	●				120	10.0								
	5486675		22-11*	●	22.000	21	21	120									
	5953252		25-11MET	●	25.000	24	24	150									
	5486683		25-11	●	25.400												
7	5997077		CH-SVUC ^{R/L} 1010H11	●		—	10	10	100	10	18	—	2	VC□□1103 E35•49~50 TFV E51	LRIS-2.5*7	CLR-15S	
	5995634		1212H11	●	—	12	12	100	12	20	—	0					
	5997085		1616H11	●	—	16	16	100	16	24	—	0					
	5997093		2020H11	●	—	20	20	100	20	28	—	0					

※Bitte verwenden Sie bei den DS-Sleeve Haltern einen Halter DMR von 16mm / 22mm, weitere Info → G103

TBP



Abb. 1

● Rechte Ausführung dargestellt

TBP-OH2

Innenkühlung

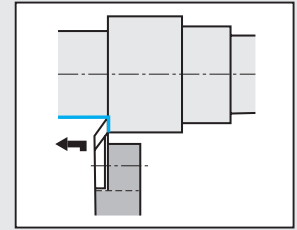
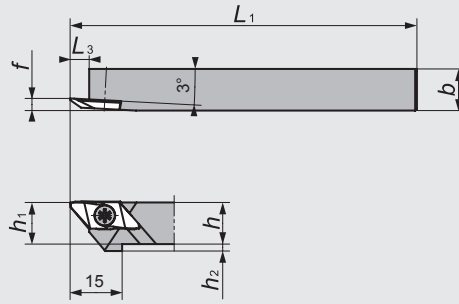

Abb. 2

● Rechte Ausführung dargestellt

TBP-OH

Innenkühlung

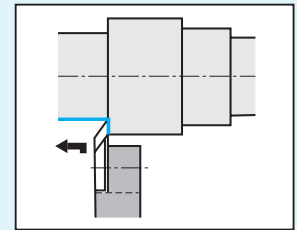
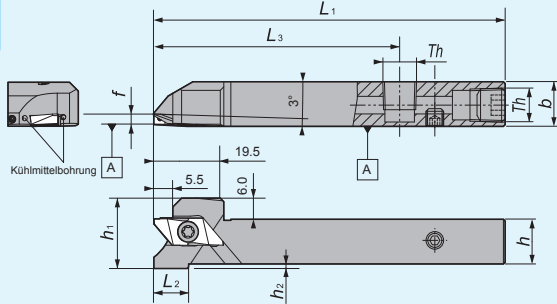

Abb. 3

● Rechte Ausführung dargestellt

Y-TBP

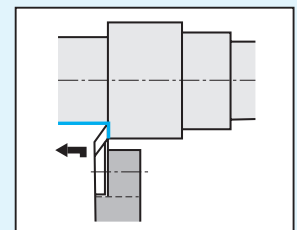
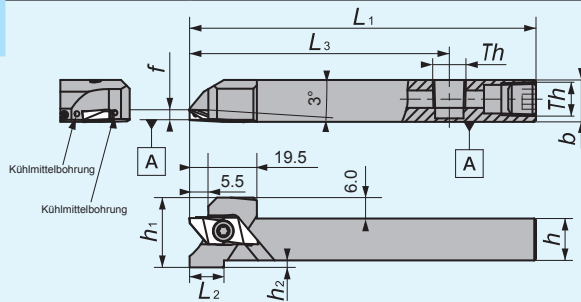

Abb. 4

☆ Rechte oder neutrale WSP verwenden
● Rechte Ausführung dargestellt

Y-TBP-OH

Innenkühlung

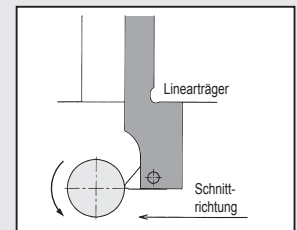
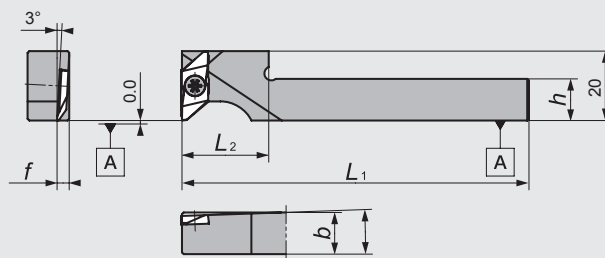

Abb. 5

☆ Rechte oder neutrale WSP verwenden
● Rechte Ausführung dargestellt

DS-TBP

DS-Halter

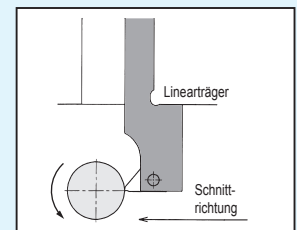
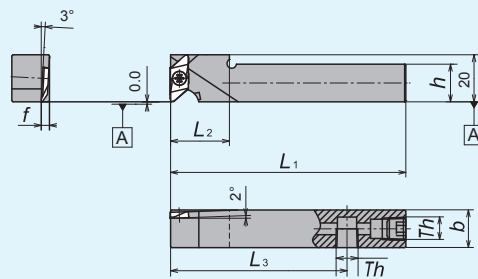

Abb. 6

☆ Rechte oder neutrale WSP verwenden
● Linke Ausführung dargestellt

Abmessungen und Ersatzteilinformationen

Abb.	Artikelnr.		Bezeichnung	Standard		Abmessungen (mm)										Platte	Ersatzteile		
	R	L		R	L	D_s	h	b	L_1	h_1	h_2	f	L_2	L_3	Spannschraube		Schlüssel		
															(A)		(B)	(A)	(B)
1	5133285	5133293	TBP $\frac{R}{L}$ 08	●	●	-	8	10	120	8	4	3.5	-	5.5	TBP	LRIS-4*10PW (A)	CLR-15S (A)		
	5873856		10H	●			10	10	100	10	2								
	5090436	5090444	10	●	●		12	12	85	12									
	5459771		12GX	●			13	13	120	13	0								
	5090451	5090469	12	●	●		16	16	100	16									
	5090477	5090485	13	●			16	16	120										
	5459789		16H	●															
5270822	5270830	16	●	●															
2	5037965		TBPR $\frac{R}{L}$ 12H-OH2	●		-	12	12	100	12	2	3.5	10	70	TBP	LRIS-4*12PW (A)	CLR-15S (A)		
	5043971		16X-OH2	●			16	16	120	16	0								
3	5925722		TBP $\frac{R}{L}$ 101 2H-OH	●		-	10	12	100	10	4	3.5	10	75	TBP	LRIS-4*10PW (A)	CLR-15S (A)		
	5925730		12H-OH	●			12	12		12	2								
	5925748		16H-OH	●			16	16		16	0								
4	5371554		Y-TBP $\frac{R}{L}$ 10S	●		-	10	10	120	-	-	3.5	-	TBP	LRIS-4*10PW(A)	CLR-15S (A)			
	5950399		10MS	●			10	10							22				
	5371588		12S	●			12	12							20				
	5950407		12MS	●			12	12							22				
5	5911508		Y-TBP $\frac{R}{L}$ 12HS-OH	●		-	12	12	100	-	-	3.5	20	-	TBP	LRIS-4*12PW (A)	CLR-15S (A)		
	5911516		16H-OH	●			16	16										25	
6		5540414	DS-TBP $\frac{R}{L}$ 19	●	●	19.050	18	18	120	-	-	10.0	-	5.5	TBP	LRIS-4*10 (B)	LLR-25S -20*65 (B)		
		5540422	20	●	●	20.000	19	19											
		5540430	25	●	●	25.400	24	24										150	

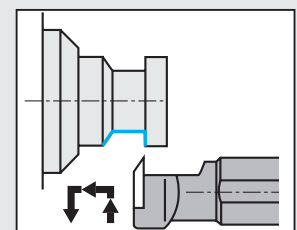
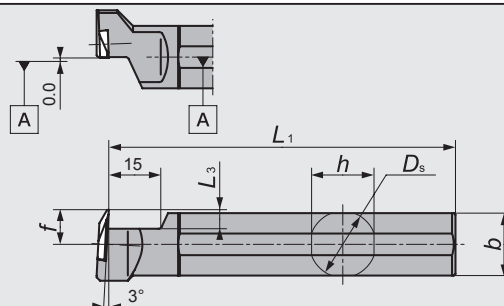
Wendeschneidplatten

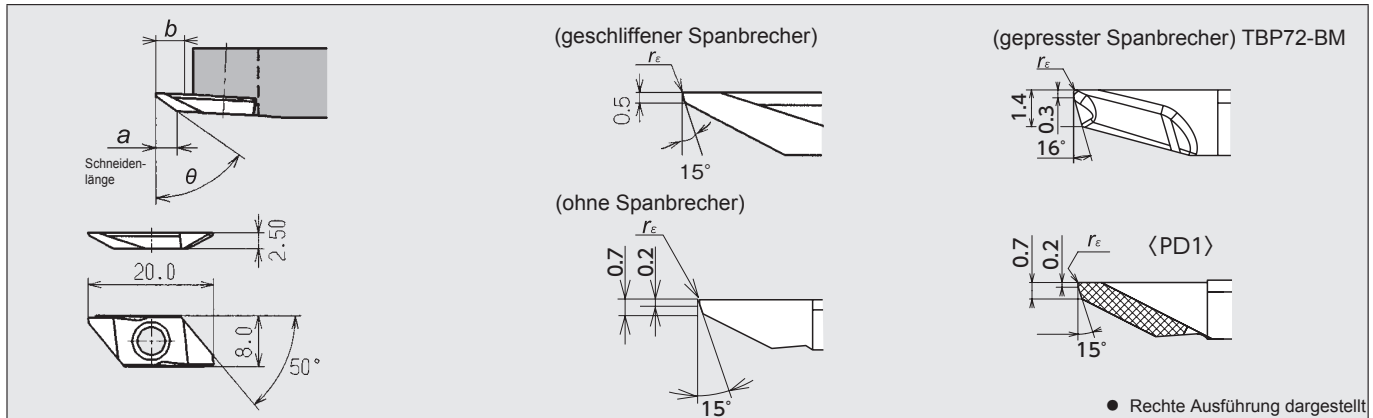

Bezeichnung	Spanbrecher	Schneidenlänge a	Max. Stechtiefe b	θ	r_e	PVD-Beschichtetes Hartmetall												Hartmetall		PKD			
						ST4		ZM3		QM3		VM1		TM4		DT4		DM4		KM1		PD1	
						R	Standard	R	Standard	L	Standard	R	Standard	L	Standard	R	Standard	R	Standard	R	Standard	R	Standard
TBP72FR05-BM 72FR10M-BM 72FR20M-BM	Ja	3.5	5.3	72°	0.05	5039524	●								5868310	●		5868401	●				
					0.08	5039532	●								5868351	●		5868419	●				
					0.18	5039540	●								5868336	●		5868393	●				
TBP55F $\frac{R}{L}$ 00 55F $\frac{R}{L}$ 10	Ja	3.0	5.3	55°	0.00		5090378	●	5090360	●			5270855	●									
					0.10		5090352	●	5090386	●			5294301	●									
TBP60F $\frac{R}{L}$ 00 60F $\frac{R}{L}$ 05 60F $\frac{R}{L}$ 10 60F $\frac{R}{L}$ 10M 60F $\frac{R}{L}$ 20 60F $\frac{R}{L}$ V	Ja	3.7	5.3	60°	0.00		5090410	●	5090428	●	5494711	●	5275508	●		5710108	●	5850805	●				
					0.05																		
					0.10		5090402	●	5090394	●	5362488	●	5269949	●		5706114	●						
					※0.08				5486964	●	5476403	●						5850813	●				
					0.2												5738844	●					
60FRV00-P	Nein	4.0			0.00		5345715	●				5264940	●	5264957	●				5299276	●			
60FRV05	Nein	4.8			0.05							5440680	●						5575675	●		5781745 (1 Ecke)	
60FRV10	Nein	4.8			0.10		5482690	●				5440698	●						5575683	●			
60FRV10-P	Nein	4.0			0.10																	5785118 (1 Ecke)	

※ Wendeschneidplatten mit der Radius-Angabe "10M" können zur Herstellung von 0,1mm Radien verwendet werden.
 ※ PD1 Wendeschneidplatten sind nur mit einer Schneidecke bestückt.

Hinterdreh-
bearbeitung

Empfohlen für Aluminiumspulen

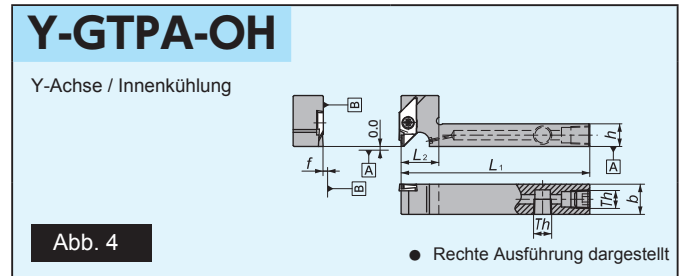
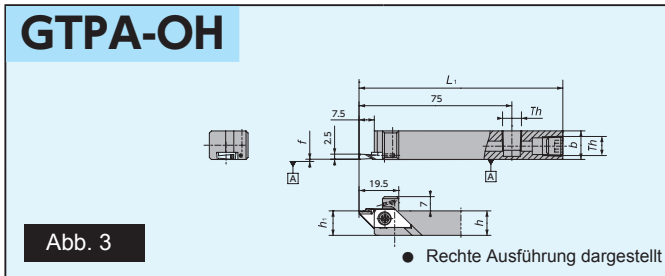
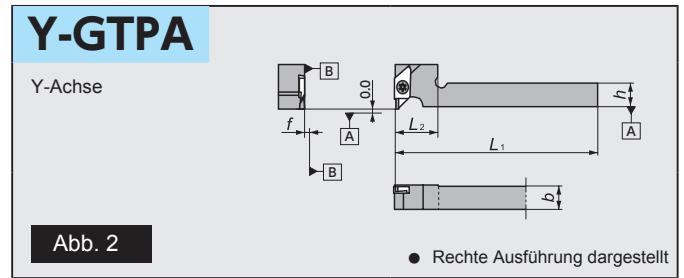
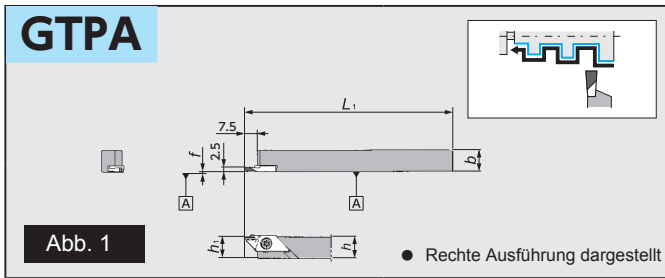

Abmessungen und Ersatzteilm Informationen

Abb.	Artikelnr.		Bezeichnung	Standard		Abmessungen (mm)						Stechtiefe (mm) w	Platte	Ersatzteile	
	R	L		R	L	h	b	L ₁	h ₁	f	L ₂			Spannschraube	Schlüssel
1	5552401		GTPA 1010	●		10	10		10			2.0 2.5	GTPA	LRIS-4 * 10PW	CLR-15S
	5552419		1212	●		12	12	120	12	0.1	—				
	5577291		1616	●		16	16		16						
2	5563820		Y-GTPA 1216	●		12	16	120	—	0.1	20	2.0 2.5	GTPA	LRIS-4 * 12PW	CLR-15S
3	5912845		GTPA 1214H-OH	●		12	14	100	12	0.1	—				
4	5930185		Y-GTPA 1014FSS-OH	●		10	14	80			15				
	5911482		1216HS-OH	●		12	16	100	—	0.1	20				
	5911490		1616H-OH	●		16	16				25				

Wendeschneidplatten

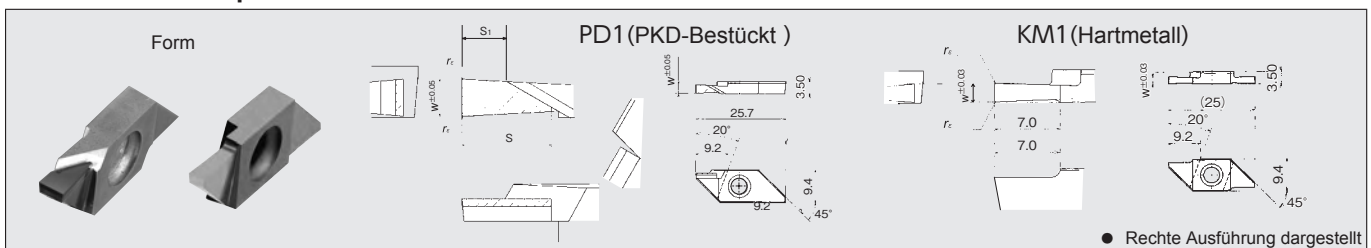

I Bezeichnung	Abmessungen (mm)				Max Schnitttiefe	PKD		Hartmetall		
	w	s	s ₁	r _ε		PD1	Standard	KM1	Standard	
GTPA20FRN01	2.0	6.0	4.0	0.1以下	5.0	5552385	●			
20FRN01		—	—		6.0				5576525	●
20FRN01-SH		4.0	2.0		3.0	5966114	●			
GTPA25FRN01	2.5	6.0	3.0	0.1以下	5.0	5552393	●			
25FRN01		—	—		6.0				5576533	●
25FRN01-081		4.0	1.0		3.0	5561808	●			

Y-GTT-OH

(Y-Achse / Innenkühlung)



Abb. 1

● Rechte Ausführung dargestellt
☆ rechte Platte auf rechtem Halter verwenden

Y-GTT

(Y-Achse)

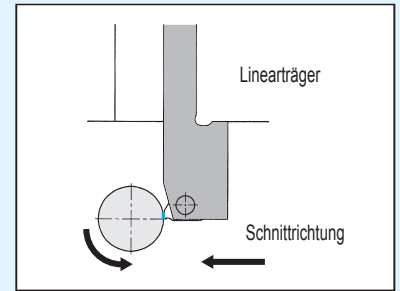
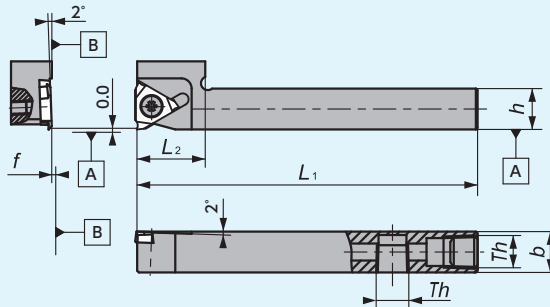
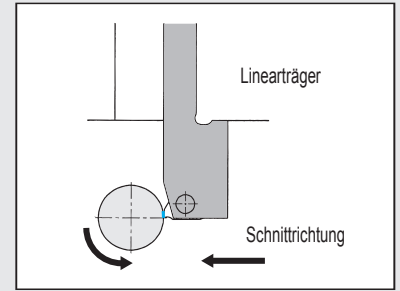
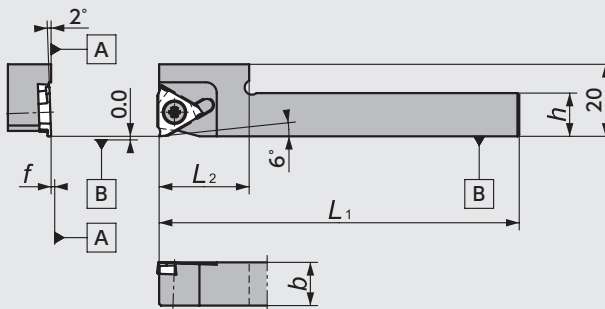

Abb. 2

● Rechte Ausführung dargestellt
☆ rechte Platte auf rechtem Halter verwenden

Abmessungen und Ersatzteilmformationen

Abb.	Artikelnr.		Bezeichnung	Standard	Abmessungen (mm)										Stechtiefe (mm) w	Platte	Ersatzteile	
	R	L			R	L	h	b	L ₁	h ₁	f	L ₂	a _r	h ₂			Spannschraube	Schlüssel
1	5911466		Y-GTT [®] / _L 12H00S-OH	●	12	12					20			0.30	GTMH32 GTMX32 H22~25 TBMH32	LR-S-4 * 10PW	CLR-15S	
	5911474		Y-GTT [®] / _L 16H00-OH	●	16	16	100	—	0	—	25	—	—	3.00 *1				
2	5371604		Y-GTT [®] / _L 10S	●							20			0.30 } 3.00 *1	LR-S-4 * 10PW	CLR-15S		
	5950415		10MS	●	10	10					22							
	5371620		12S	●			120	—	0	—	20	1.6	—					
	5950472		12MS	●	12	12					22							