

GTT



Abb. 1



● Rechte Ausführung dargestellt

GTT-OH2

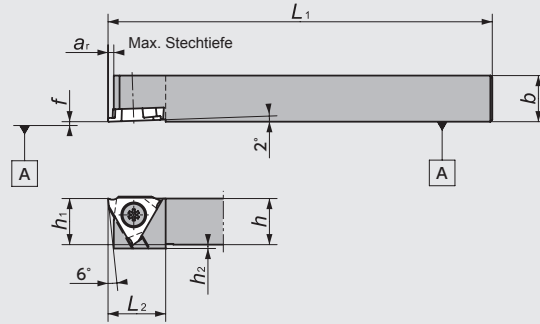
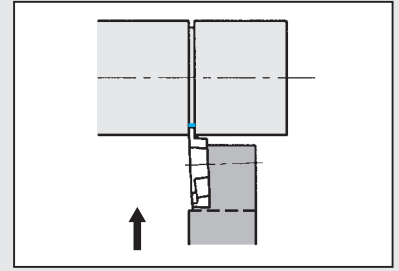

Abb. 2



● Rechte Ausführung dargestellt

GTT-OH

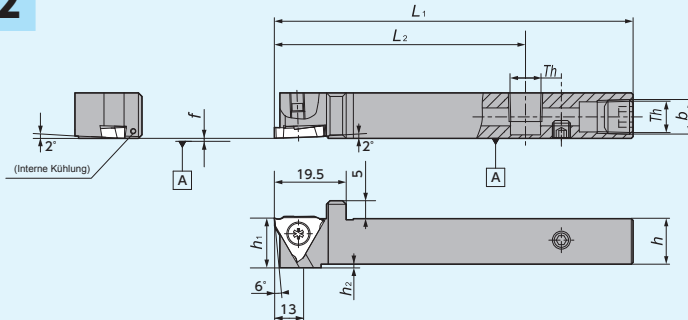
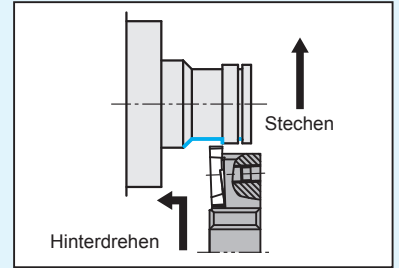
(Innenkühlung)



Abb. 3



● Rechte Ausführung dargestellt

CH-GTT

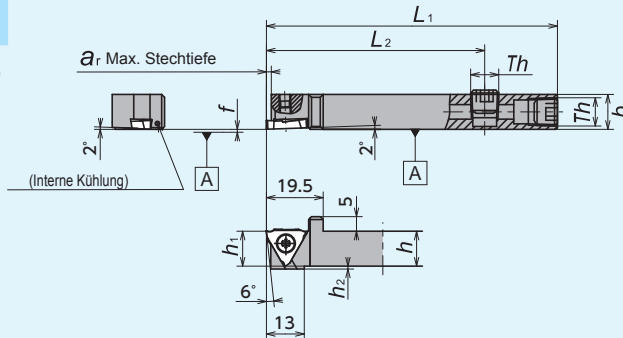
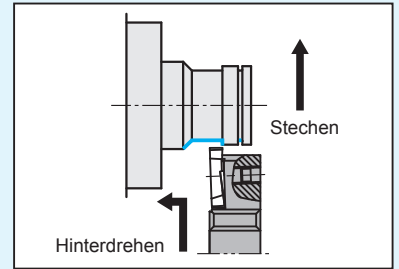

Abb. 4



☆ Rechte oder neutrale WSP verwenden
● Linke Ausführung dargestellt

DS-GTT

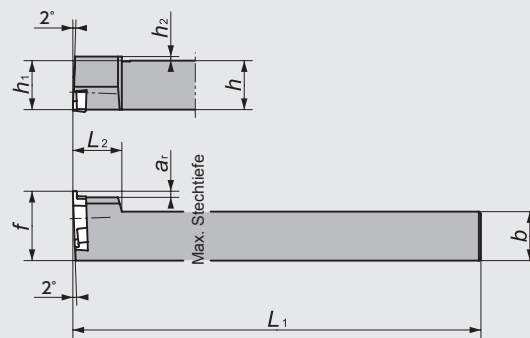
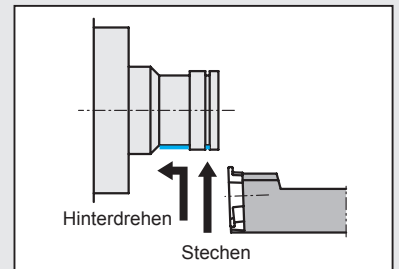
(DS-Halter)







Abb. 5

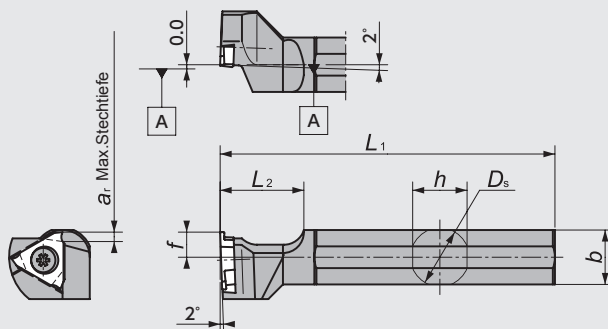
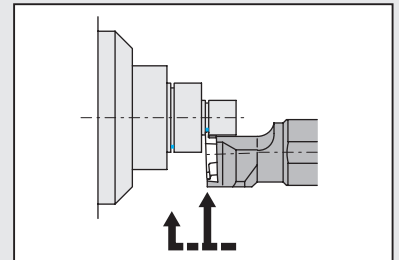

☆ Rechte oder neutrale WSP verwenden
● Linke Ausführung dargestellt

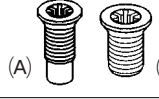
Abmessungen und Ersatzteilmformationen

Abb.	Artikelnr.		Bezeichnung	Standard		Abmessungen (mm)										Stechtiefe (mm) w	Platte 	Ersatzteile	
	R	L		R	L	h	b	L ₁	h ₁	f	L ₂	a _r	h ₂	D _s	Spannschraube			Schlüssel	
1	5107305	5107313	GTTR_L08F00	●	●		8	80										 Rechts : LR-S-4 * 10PW (A) Links : LR-S-4 * 5,8 (B) LR-S-4 * 10PW (A) Rechts : LR-S-4 * 10PW (A) Links : LR-S-4 * 5,8 (B) CLR-15S (A) LR-S-4 * 10PW (A) CLR-15S (A) GTMH32 GTXM32 H22~25 TBMH32 G63	
	5608682		0810F00	●		8	10		8										
	5107206	5107214	08K00	●	●		8												
	5608690		0810K00	●			10												
	5107321	5107339	10F00	●	●	10	10	80											
	5107222	5107230	10K00	●	●			120			1.6		3						
	5107347	5107354	12F00	●	●			80					1						
	5107248	5107255	12K00	●	●			120											
	5459896	5551387	16H00	●	●			100											
	5173687	5173679	16K00	●	●			120					0						
	5530852	5780317	20K00	●	●	20	20	125	20										
	5780309	5780291	25M00	●	●	25	25	150	25	0	15								
	5107362	5107370	10F15	●	●			80											
	5107263	5107271	10K15	●	●	10	10	120					3						
	5537220	5537147	12F15	●	●			80											
	5537246	5537162	12K15	●	●			120					1						
	5537261	5537188	16H15	●	●			100											
	5537287	5537204	16K15	●	●			120					0						
	5107388	5107396	10F25	●	●			80											
	5107289	5107297	10K25	●	●	10	10	120					3						
5537238	5537154	12F25	●	●			80												
5537253	5537170	12K25	●	●			120					1							
5537279	5537196	16H25	●	●			100												
5537295	5537212	16K25	●	●			120					0							
2	5035381		GTTR_L12H00-OH2	●		12	12	100	12	0	70	1.6	1						
	5043997		16X00-OH2	●		16	16	120	16				0						
3	5921705		GTTR_L1012H00-OH	●		10			10										
	5890157		GTTR12H00-OH	●		12		100	12	0	70	1.6	1						
	5921713		GTTR_L16H00-OH	●		16	16		16				0						
4	5659248		CH-GTTR_L10H00	●		10	10	100	10	15			3						
	5659255		12H00	●		12	12	100	12	17	12	1.5	1						
	5960836		16H00	●		16	16	100	16	21			0						
5	5348560		DS-GTTR_L14F	●		13	13	80											
	5348081		15H	●		15	15	100											
	5341532		16X ※2	●				95											
	5278288		19	●		18	18												
	5278304		20	●		19	19	120			20	1.6							
	5324041		22 ※2	●		21	21												
	5483433		25MET	●		24	24	150											
	5317144		25	●		24	24	120											
5937693		32	●		30	30	150												

※1 Stechtiefe je nach Platte

※2 Bitte verwenden Sie bei den DS-Sleeve Haltern einen Halter DMR von 16mm / 22mm

Y-GTT-OH

(Y-Achse / Innenkühlung)



Abb. 1

● Rechte Ausführung dargestellt
☆ rechte Platte auf rechtem Halter verwenden

Y-GTT

(Y-Achse)

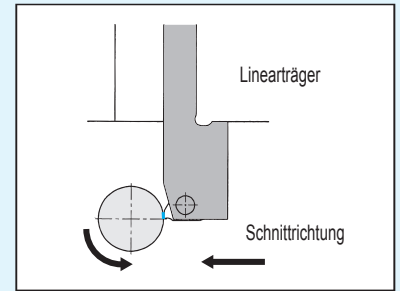
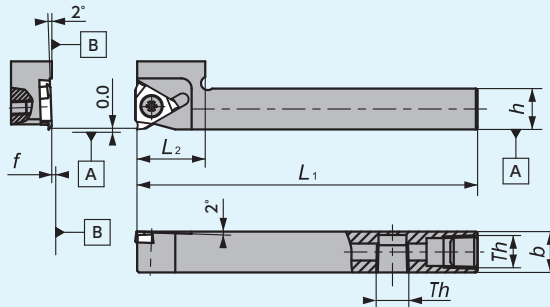

Abb. 2

● Rechte Ausführung dargestellt
☆ rechte Platte auf rechtem Halter verwenden

Abmessungen und Ersatzteilmformationen

Abb.	Artikelnr.		Bezeichnung	Standard	Abmessungen (mm)										Stechtiefe (mm) w	Platte	Ersatzteile	
	R	L			R	L	h	b	L ₁	h ₁	f	L ₂	a _r	h ₂			Spannschraube	Schlüssel
1	5911466		Y-GTT [®] /L12H00S-OH	●	12	12					20			0.30	GTMH32 GTMX32 H22~25 TBMH32	LR-S-4 * 10PW	CLR-15S	
	5911474		Y-GTT [®] /L16H00-OH	●	16	16	100	—	0	—	1.6	—	25	3.00 *1				
2	5371604		Y-GTT [®] /L10S	●							20			0.30 } 3.00 *1	LR-S-4 * 10PW	CLR-15S		
	5950415		10MS	●	10	10					22							
	5371620		12S	●			120	—	0	—	1.6	—	20					
	5950472		12MS	●	12	12					22							

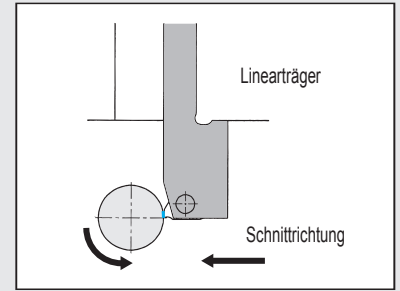
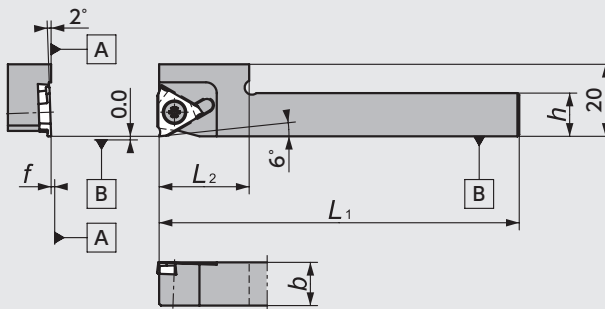
NGTN

Ohne Überstand



Abb. 1

● Rechte Ausführung dargestellt

NGTB

Mit Überstand

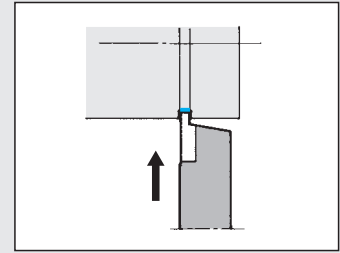
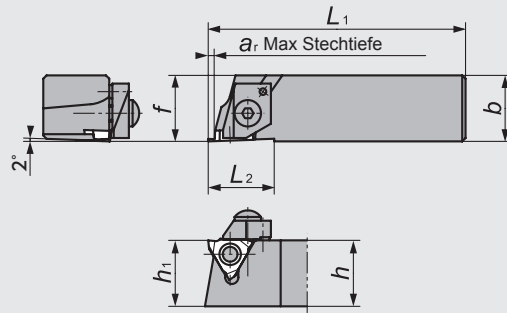

Abb. 2

● Rechte Ausführung dargestellt

NGTA

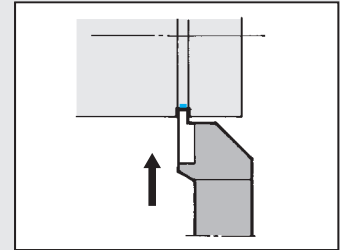
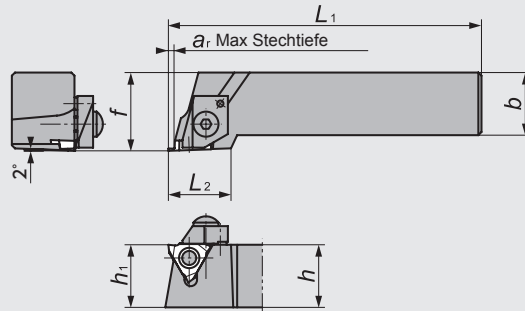

Abb. 3

● Linke Ausführung dargestellt

☆ rechte Platte auf rechtem Halter verwenden

Abmessungen und Ersatzteilinformationen

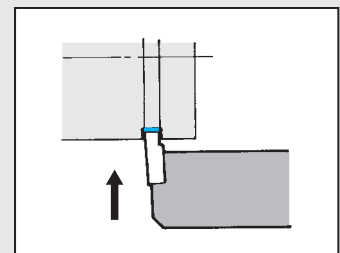
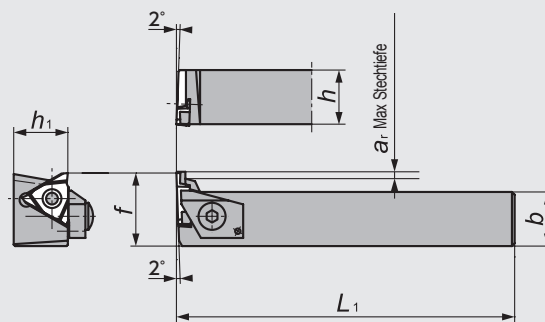
Abb.	Artikelnr.		Standard	Abmessungen (mm)										Stechtiefe (mm)	Platte	Ersatzteile					
	R	L		Bezeichnung		R	L	h	b	L ₁	h ₁	f	L ₂			a _r	h ₂	w	Klemmplatte	Klemmbolzen	Feder
1	5525928	5525738	NGTN	161632-00	●	●									1.6	0.30~3.00 ※1	GTMH32 GTMX32 H22~25	CPR/L5S	AOS-5*20	ASG-5	LW-2.5
	5534110		161632-15	●		16	16	78	16	16	20			2.7	1.45~3.00						
	5534128		161632-25	●												2.50~3.00					
2	5542295		NGTB	202032-00S	●										1.6	0.30~3.00 ※1	GTMH32 GTMX32 H22~25	CPR/L5	AOS-5*25	ASG-5	LW-2.5
	5537717		202032-15S	●		20	20	125	20	25				2.7	1.45~3.00						
	5553243		202032-25S	●							25					2.50~3.00					
	5549563		252532-00S	●										1.6	0.30~3.00 ※1						
	5545801		252532-15S	●		25	25	150	25	30				2.7	1.45~3.00						
	5553417		252532-25S	●												2.50~3.00					
3	5536370		NGTA	202032-00S	●										1.6	0.30~3.00 ※1	GTMH32 GTMX32 H22~25	CPR/L5※	AOS-5*25	ASG-5	LW-2.5
	5536388		202032-15S	●		20	20	125	20	25				2.7	1.45~3.00						

※1 Stechtiefe je nach Platte

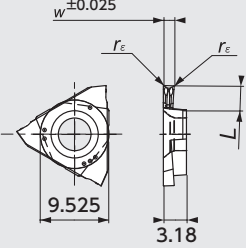

Stechen & Längsdrehen

GTMH32-GX

Form	Bezeichnung	Abmessungen (mm)			Stechtiefe		PVD-Beschichtetes Hartmetall							
		w	L	r _ε	Stechen	Längsdrehen	ST4		TM4		DM4			
							Standard	R	Standard	R	Standard	R		
Geeignet zum Längsdrehen  	GTMH32033RGX	0.33	0.6	0.05	0.25	—	5039136	●	5019468	●	5019450	●		
	043RGX	0.43	1.2				5039144	●	5019443	●	5019435	●		
	050RGX	0.50					5039151	●	5019419	●	5019401	●		
	053RGX	0.53	2.0				5039169	●	5019393	●	5019336	●		
	075RGX	0.75					1.6	0.75	5039177	●	5910765	●	5910898	●
	095RGX	0.95						1.50	5039185	●	5922224	●	5922216	●
	100RGX	1.00	3.0	2.7	2.00	5039193	●		5910815	●	5910906	●		
	100RGX01					0.1	5039201	●	5910823	●	5910963	●		
	150RGX	1.50	3.0	2.7	2.00	5039219	●	5910740	●	5910914	●			
	150RGX01					0.1	5039227	●	5910849	●	5910971	●		
	150RGX02					0.2	5039235	●	5910864	●	5910997	●		
	200RGX	2.00	3.0	2.7	2.00	5039243	●	5910732	●	5910930	●			
	200RGX01					0.05	5039250	●	5910856	●	5910989	●		
	200RGX02					0.1	5039268	●	5910872	●	5911003	●		
	300RGX					0.2	5039276	●	5910724	●	5910948	●		
	300RGX02	3.00	0.05	5039284	●	5910880	●	5911011	●					
			0.2											

● Rechte Ausführung dargestellt

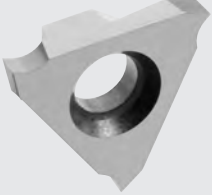
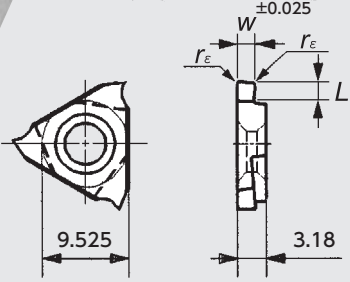
GTMH32-E

Form	Bezeichnung	Abmessungen (mm)				PVD-Beschichtetes Hartmetall			
		w	L	r _ε	Max. Stechtiefe	ZM3			
						R	Standard	L	Standard
  	GTMH32033^R/_LE	0.33	0.6	0.03	0.3	5108766	●	5109046	●
	043^R/_LE	0.43	1.2			0.9	5108758	●	5109038
	053^R/_LE	0.53		2.0	1.6	5108774	●	5109020	●
	075^R/_LE	0.75	5108790			●	5109012	●	
	077^R/_LE	0.77	5920574			●	5965264	●	
	095^R/_LE	0.95	5108808			●	5109004	●	
	097^R/_LE	0.97	5919980			●	5965272	●	
	100^R/_LE	1.00	5108816			●	5108998	●	
	103^R/_LE	1.03	0.05	2.7	5965298	●	5965306	●	
	120^R/_LE	1.20			5108824	●	5108980	●	
	125^R/_LE	1.25	3.0	2.7	5373360	●			
	140^R/_LE	1.40			5108782	●	5108907	●	
	145RE	1.45			5231667	●			
	150^R/_LE	1.50			5108899	●	5108972	●	
	175RE	1.75			5919998	●			
	180^R/_LE	1.80			5108881	●	5108964	●	
	200^R/_LE	2.00	0.1	1.6	5108873	●	5108956	●	
	225^R/_LE	2.25			5108865	●	5108949	●	
	250^R/_LE	2.50			5108857	●	5108931	●	
	275^R/_LE	2.75			5108840	●	5108923	●	
	300^R/_LE	3.00	3.0	2.7	5108832	●	5108915	●	
	100^R/_LE01	1.00			5109079	●	5109087	●	
	120^R/_LE01	1.20			5109277	●	5109251	●	
150^R/_LE01	1.50	0.1			2.7	5109061	●	5109269	●
200^R/_LE01	2.00		5109053	●		5109244	●		

● Rechte Ausführung dargestellt

GTMH32 (Voll-radius)

Form	Bezeichnung	Abmessungen (mm)				PVD-Beschichtetes Hartmetall			
		w	L	r _ε	Max. Stechtiefe	ZM3			
						R	Standard	L	Standard
<p>• Rechte Ausführung dargestellt</p>	GTMH32050^R/_LE025	0.50	1.2	0.25	0.9	5446125	●		
	070^R/_LE035	0.70	2.0	0.35	1.6	5446141	●		
	100^R/_LE05	1.00		0.50		5160759	●		
	150^R/_LE075	1.50	0.75	5501200		●			
	200^R/_LE10	2.00	3.0	1.00	2.7	5160775	●		
	250^R/_LE125	2.50		1.25		5921671	●		
	300^R/_LE15	3.00		1.50		5436720	●		

GTMH • X32 (Flach-Spanbrecher)

Form	Bezeichnung	Abmessungen (mm)				PVD-Beschichtetes Hartmetall				Hartmetall				
		w	L	r _ε	Max. Stechtiefe	ZM3				KM1				
						R	Standard	L	Standard	R	Standard	L	Standard	
Kurz <p>• Rechte Ausführung dargestellt</p>	GTMX32100^R/_LSS	1.00	2.0	0.05	1.6	5523345	●							
	150^R/_LSS	1.50	3.0			2.7	5523337	●						
	200^R/_LSS	2.00					5523329	●						
	GTMX32100^R/_LSSH	1.00	2.0	0.05	1.6					5599394	●			
	150^R/_LSSH	1.50	3.0			2.7					5599386	●		
	200^R/_LSSH	2.00								5599378	●			
Lang <p>• Rechte Ausführung dargestellt</p>	GTMX32100^R/_LLS	1.00	2.0	0.05	1.6	5523295	●							
	150^R/_LLS	1.50	3.0			2.7	5523303	●						
	200^R/_LLS	2.00					5523311	●						



SBG

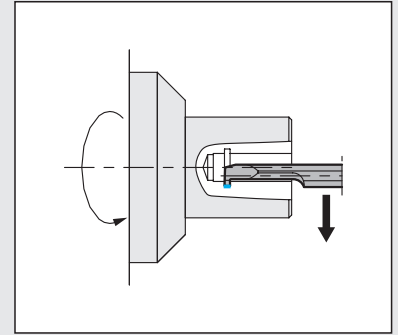
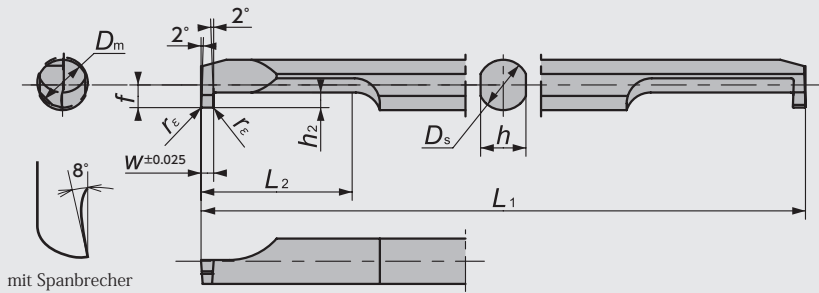

Form	Bezeichnung	Min. Durchmesser (mm) D_m	Abmessungen (mm)								PVD-Beschichtetes Hartmetall	
			w	D_s	L_1	L_2	f	h	h_2	r_ϵ	ZM3	
Kurz	SBG030050RB-S	3.0	0.50	3.0	50	4.5	1.3	2.7	0.8	0.05	5815782	●
	030075RB-S		0.75								5815808	●
	030100RB-S		1.00								5815816	●
	030150RB-S		1.50								5815824	●
	SBG040050RB-S	4.0	0.50	4.0	60	6	1.8	3.6	1.0	0.05	5815832	●
	040075RB-S		0.75								5815840	●
	040100RB-S		1.00								5815857	●
	040150RB-S		1.50								5815865	●
	SBG050050RB-S	5.0	0.50	5.0	70	7.5	2.3	4.5	1.2	0.05	5815881	●
	050100RB-S		1.00								5815899	●
	050150RB-S		1.50								5815907	●
	050200RB-S		2.00								5815915	●
	SBG060100RB-S	6.0	1.00	6.0	80	7.5	2.8	5.4	1.8	0.05	5815931	●
	060150RB-S		1.50								5815949	●
	060200RB-S		2.00								5815956	●
	SBG080100RB-S	8.0	1.00	8.0	80	8.5	3.8	7.3	2.2	0.05	5815964	●
080150RB-S	1.50		5815980								●	
080200RB-S	2.00		5815998								●	
Normal	SBG030050RB	3.0	0.50	3.0	50	9	1.3	2.7	0.8	0.05	5652821	●
	030075RB		0.75								5652839	●
	030100RB		1.00								5652847	●
	SBG040050RB	4.0	0.50	4.0	60	12	1.8	3.6	1.0	0.05	5652797	●
	040075RB		0.75								5652805	●
	040100RB		1.00								5652813	●
	SBG050050RB	5.0	0.50	5.0	70	20	2.3	4.5	1.2	0.05	5652854	●
	050100RB		1.00								5652862	●
	050150RB		1.50								5652870	●
	SBG060100RB	6.0	1.00	6.0	80	20	2.8	5.4	1.8	0.05	5704846	●
	060150RB		1.50								5704838	●
	060200RB		2.00								5704820	●
	SBG080100RB	8.0	1.00	8.0	80	20	3.8	7.3	2.2	0.05	5704895	●
	080150RB		1.50								5704903	●
	080200RB		2.00								5704911	●

S-BG (Mogul Bar)



Abb. 1

● Rechte Ausführung dargestellt
Linke Platte verwenden

BG

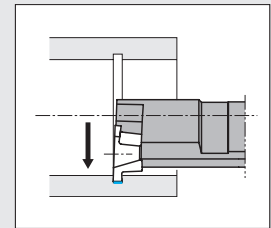
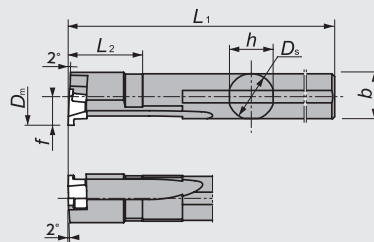

Abb. 2

● Rechte Ausführung dargestellt
Linke Platte verwenden

Abmessungen und Ersatzteilinformationen

Abb.	Artikelnr.		Bezeichnung	Standard		Min. Durchmesser (mm) D_m	Stechtiefe (mm) a_r	Abmessungen (mm)					Stechbreite (mm) w	Platte	Ersatzteile		
	R	L		R	L			D_s	h	b	L_1	f			L_2	Spannschraube	Schlüssel
1	5854500		S08H-BG$\frac{R}{L}$10D10	●		10.0	1.0	8	7.7	7.85	120	5.0	20	0.50 ~ 2.00	GTG10	LR-S-2.5*6.8	CLR-15S (A)
	5854518		S10K-BG$\frac{R}{L}$10D12	●		12.0	1.0	10	9.6	9.8	120	6.0	25				
2	5711585		BG$\frac{R}{L}$08-00S	●		10.0	1.0	8	7.0	7.5	125	5.0	20	0.50 ~ 2.00	GTG10	LR-S-2.5*6.8	CLR-15S (A)
	5711593		08-10S	●		10.0	1.0	8	7.0	7.5	125	5.0	20	1.50 ~ 2.00			
	5711601		10-00S	●		12.0	1.0	10	9.0	9.5	150	6.0	25	0.50 ~ 2.00	GTG10	LR-S-2.5*6.8	CLR-15S (A)
	5711619		10-10S	●		12.0	1.0	10	9.0	9.5	150	6.0	25	1.50 ~ 2.00			
	5711627		12-00S	●		14.0	2.0	12	11.0	11.5	180	7.0	30	1.00 ~ 2.00	GTG14	LR-S-3*7.8	RLR-20S (B)
	5711635		12-12S	●		14.0	2.0	12	11.0	11.5	180	7.0	30	1.75 ~ 2.00			
	5711643		14-00S	●		16.0	2.0	14	13.0	13.5	180	8.0	35	1.00 ~ 2.00	GTG14	LR-S-3*7.8	RLR-20S (B)
	5711650		14-12S	●		16.0	2.0	14	13.0	13.5	180	8.0	35	1.75 ~ 2.00			
	5536362		16	●		20.0	3.0	16	15.0	15.5	200	10.0	40	1.50 ~ 2.00	GTG20	LR-S-3*7.8	RLR-20S (B)
	5435433		20	●		25.0	3.0	20	19.0	19.5	200	12.0	40				

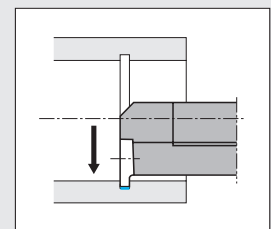
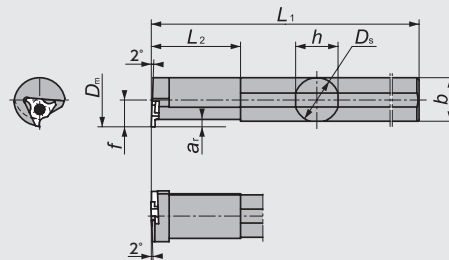
Wendeschneidplatten

Form	Bezeichnung	Abmessungen (mm)					PVD-Beschichtetes Hartmetall					
		w	Max. Stechtiefe	L	r_e	d_1	TM4	Standard	ZM3	Standard	QM3	Standard
<p>● Left-Hand style shown</p>	GTG10050FL005	0.50	1.0	1.2	0.05	5.56	5853130	●				
	10075FL005	0.75					5853114	●				
	10100FL005	1.00					5853098	●				
	10150FL005	1.50					5853080	●				
	10200FL005	2.00					5853072	●				
	GTG10050FL00	0.50									5514088	●
	10065FL00	0.65	1.0	1.2	0.05	5.56			5514104	●		
	10075FL00	0.75							5376835	●		
	10100FL00	1.00							5376843	●		
	10150FL00	1.50							5376850	●		
10200FL01	2.00							5357884	●			
GTG14100FL00	1.00									5376868	●	
14150FL00	1.50	2.0	2.2	0.05	7.94			5376876	●			
14200FL01	2.00							5376884	●			
GTG20150FL	1.50	3.0	3.2	0.2	9.525					5396239	●	
20200FL	2.00									5376991	●	



NBH Schaftdurchmesser ϕ 15.875 ~ 19.05



Abb. 1

NBH Schaftdurchmesser ϕ 20.0 ~ 32.0

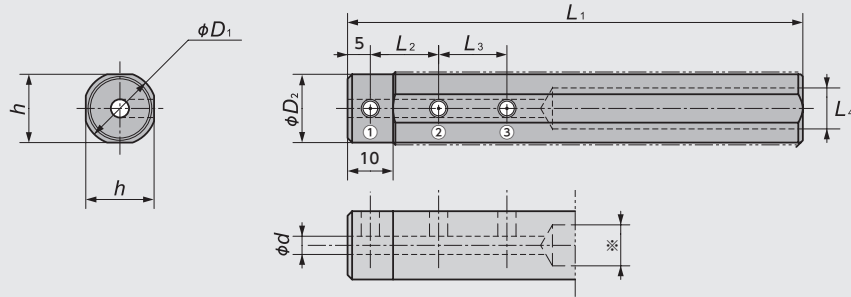
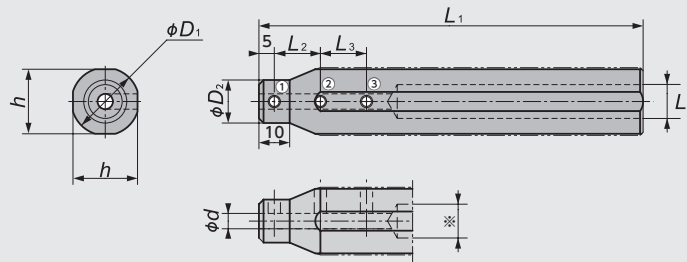

Abb. 2

Abmessungen und Ersatzteilm Informationen

Abb.	Artikelnr.	Bezeichnung	Standard	Abmessungen (mm)								Klemmschraube			Schlüssel
				ϕd	ϕD_1	ϕD_2	h	L_1	L_2	L_3	L_4	①	②	③	
1	5631403	NBH02015H	●	2.0	15.875	15	15	100	10	—	9.0	SS0406F	SS0406F	—	LW-2
	5702915	02515H	●	2.5											
	5631411	03015H	●	3.0											
	5586110	03515H	●	3.5											
	5586128	04015H	●	4.0											
	5585997	04515H	●	4.5											
	5585989	05015H	●	5.0											
	5585971	06015H	●	6.0											
	5585963	08015H	●	8.0											
	5631429	NBH02016H	●	2.0											
	5702899	02516H	●	2.5											
	5631437	03016H	●	3.0											
	5586102	03516H	●	3.5											
	5586094	04016H	●	4.0											
	5586086	04516H	●	4.5											
5586078	05016H	●	5.0												
5586060	06016H	●	6.0												
5774195	07016H	●	7.0												
5586052	08016H	●	8.0												
5631445	NBH02019K	●	2.0	19.05	18	18	125	15	—	11.0	SS0408F	SS0408F	—	LW-2	
5702907	02519K	●	2.5												
5631452	03019K	●	3.0												
5586045	03519K	●	3.5												
5586037	04019K	●	4.0												
5586029	04519K	●	4.5												
5586011	05019K	●	5.0												
5586003	06019K	●	6.0												
5774203	07019K	●	7.0												
5586227	08019K	●	8.0												
5586219	10019K	●	10.0												