

## CTPS Series

### CTPS

Best for up to 10mm diameter material

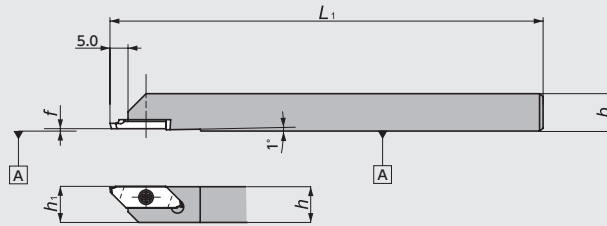
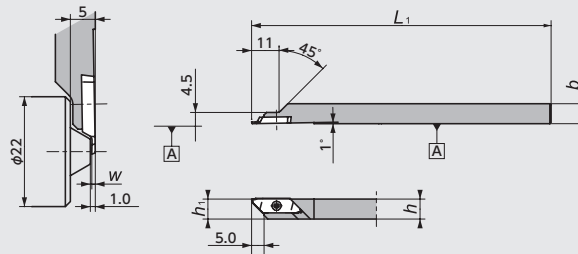

Figure-1

● Right-Hand style shown

### CTPSR-SUB

Best for up to 4mm diameter material



● Right-Hand style shown

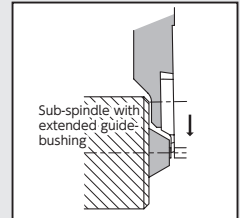

## CTPS Series - Toolholders

Figure	Code No.	Item Number	Stock	Max. Cut-off Dia (mm) $\phi D$	Dimensions (mm)					Gage insert	Spare Parts	
					$h$	$b$	$L_1$	$h_1$	$f$		Clamp Screw	Wrench
1	5346572	<b>CTPSR10 R12</b>	●	<b>10.0</b>	10	10	120	10	0.0			
	5397187		●		12	12		12				
2	5486717	<b>CTPSR08-SUB04</b>	●	<b>4.0</b>	8	8	120	8	—	CTPS-001	LRIS-2.5*4.5	CLR-15S

☆ All the inserts can use the same toolholder CTPS series → G98

## CTPS Series - Inserts

### CTPS

Shape	Item Number	Chip-breaker	*1 Max. Cut-off Dia (mm) $\phi D$	Dimensions (mm)				PVD Coated Carbide			
				$w$	$A$	$\theta$ *2	$r_e$	ZM3	Stock	VM1	Stock
(with Chipbreaker)  ● Right-Hand style shown	<b>CTPS12FR</b>	Yes	<b>4.0</b>	1.2	0.37	16°	0.05	5346275	●	5362587	●
	<b>15FR</b>		5.0	1.5	0.46			5346267	●	5362595	●
	<b>18FR</b>		8.5	1.8	0.55			5346283	●	5362603	●
	<b>20FR</b>		10.0	2.0	0.61			5374210	●	5374194	●
(without Chipbreaker) <b>Mirror finish</b>  ● Right-Hand style shown	<b>CTPS12FRV</b>	No	<b>4.0</b>	1.2	0.47	20°	0.0	5346937	●	5362611	●
	<b>15FRV</b>		5.0	1.5	0.58			5346929	●	5362629	●
	<b>18FRV</b>		8.5	1.8	0.70			5346945	●	5362637	●
	<b>20FRV</b>		10.0	2.0	0.77			5374202	●	5374228	●

\*1: Max. cut-off diameter shows when X end point is 0.0. For more information, see page G67.

\*2: All angles shown are obtained when insert is set in the holder.

### CTPS-001

Shape	Item Number	Chip-breaker	*1 Max. Cut-off Dia (mm) $\phi D$	Dimensions (mm)				PVD Coated Carbide	
				$w$	$A$	$\theta$ *2	$r_e$	ZM3	Stock
 ● Right-Hand style shown	<b>CTPS07FRN-001</b>	Yes	<b>4.0</b>	0.7	0.23	16°	0.05	5460670	●
	<b>CTPS07FR-001</b>							5441852	●
	<b>CTPS07FRV-001</b>							5441860	●

\*1: Max. cut-off diameter shows when X end point is 0.0. For more information, see page G67.

\*2: All angles shown are obtained when insert is set in the holder. **G73**

# SS Tools for Cutting off

Unique Swiss Tooling

Front Turning

Back Turning

Cut-off

Original Series

## CTP Series Max. Cut-off Dia. ~ 12.0mm

### CTP

Screw accessible from both sides

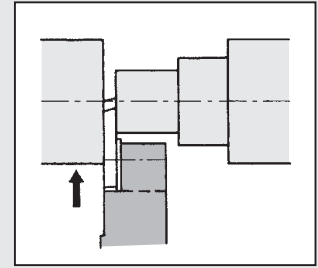
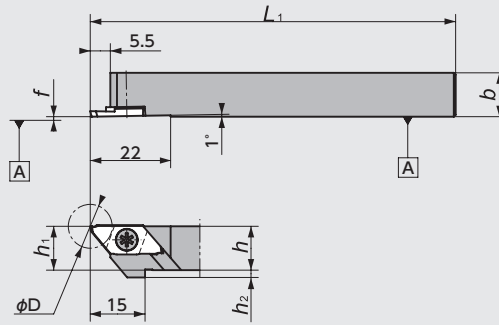

● Right-Hand style shown

Figure-1

### CTP-OH2

(Coolant through)  
Screw accessible from both sides

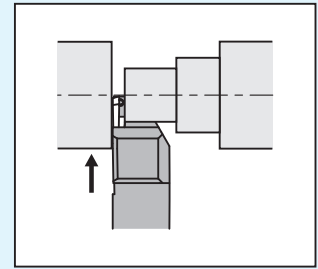
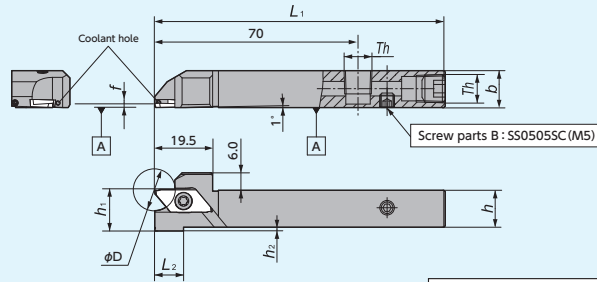

● Right-Hand style shown

Figure-2 ● Left-Hand holders are designed for Right-Hand machines

Th (Screw parts A)  
1212 size : SPR1/8 (Rc1/8)

### CTP-OH

(Coolant through)  
Screw accessible from both sides

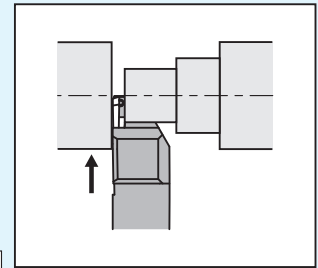
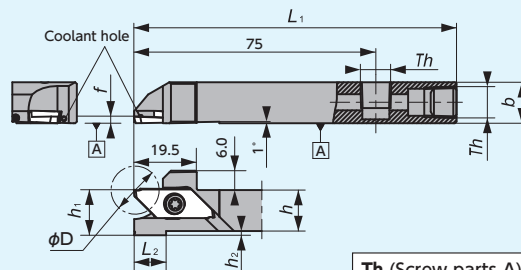

● Right-Hand style shown

Figure-3 ● Left-Hand holders are designed for Right-Hand machines

Th (Screw parts A)  
1012 size : SS0605SC (M6×1.0)  
1212/1616 size : SPR1/8 (Rc1/8)

### CTPR-SUB

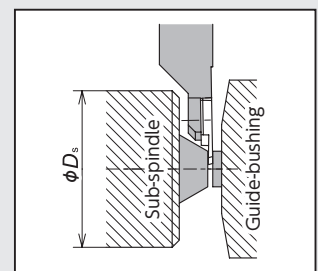
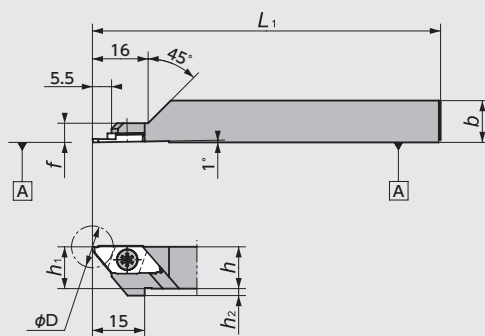

● Right-Hand style shown

Figure-4

φDs  
CTPR-SUB : φ 30mm

### CTPL-SUB

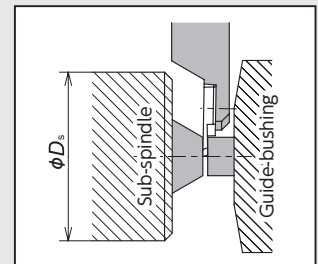
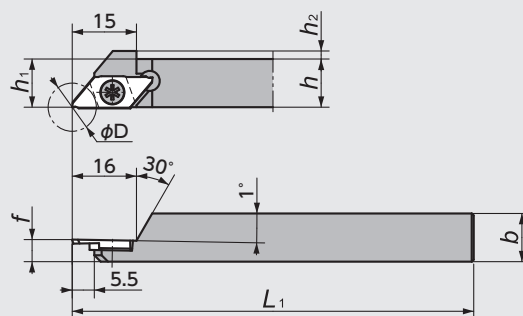







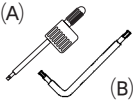

● Left-Hand style shown

Figure-5

φDs  
CTPL-SUB : φ 30mm

## CTP Series - Toolholders

Figure	Code No.		Item Number	Stock		Max. Cut-off Dia (mm) $\phi D$	Dimensions (mm)						Gage insert 	Spare Parts			
	R	L		R	L		$h$	$b$	$L_1$	$h_1$	$h_2$	$L_2$		$f$	Clamp Screw (A)  (B) 		Wrench (A)  (B) 
1	5131362	5131354	<b>CTP<sup>R/L</sup> 08</b>	●	●	12.0※	8		120	8	4	0	0.0	CTP-CX CTP CTP-X CTPX <b>G76~79</b>		LRIS-4*10PW (A)	CLR-15S (A)
	5873849	5893458	<b>10H</b>	●	●		10	10	100	10	2	0					
	5089644	5089636	<b>10</b>	●	●		120										
	5459730	5459748	<b>12GX</b>	●	●		12	12	85	12							
	5089651	5089669	<b>12</b>	●	●		120										
	5089677	5089685	<b>13</b>	●	●		13	13		13	0	0					
	5459755		<b>16H</b>	●			16	16	100	16							
	5183496	5183504	<b>16</b>	●	●		120										
2	5037874	5037866	<b>CTP<sup>R/L</sup> 12H-OH2</b>	●	●	12.0※	12	12	100	12	2	10	1.5※	CTP-CX CTP CTP-X CTPX <b>G76~79</b>		LRIS-4*12PW (A)	CLR-15S (A)
3	5921853	5921861	<b>CTP<sup>R/L</sup> 1012H-OH</b>	●	●	12.0※	10	12		12	4	19	1.5※	CTP-CX CTP CTP-X CTPX <b>G76~79</b>		LRIS-4*12PW (A)	CLR-15S (A)
	5918651	5918040	<b>12H-OH</b>	●	●		12	12	100		2	10					
	5921879	5921887	<b>16H-OH</b>	●	●		16	16		16	0	0					
4	5571831		<b>CTPR 08-SUB</b>	●		12.0※	8	8	120	8	4	0	5.5	CTP-CX CTP-FR (N) (V) (NV) CTP-FRX (FRNX) CTPX-FR (N) <b>G76~79</b>		LRIS-4*5 (B)	LLR-25S (B)
	5607999		<b>08J-SUB</b>	●			110										
	5391610		<b>10F-SUB</b>	●			10	10	80	10	2	0					
	5605282		<b>10KX-SUB</b>	●			120										
	5474580		<b>12GX-SUB</b>	●			12	12	85	12	0	0					
	5391628		<b>12-SUB</b>	●			120										
5		5570791	<b>CTPL 08-SUB</b>	●		12.0※	8	8	120	8	4	0	5.5	CTP-CX CTP-FLK CTP-FLKV CTP-FLN CTP-FLNV CTPX-FLN CTPX-FLNX <b>G76~79</b>		LRIS-4*5 (B)	LLR-25S (B)
		5608005	<b>08J-SUB</b>	●			110										
		5499389	<b>10GX-SUB</b>	●			10	10		10	2	0					
		5482534	<b>12GX-SUB</b>	●			12	12	85	12	0	0					

※ Would be changed by insert.

## CTPA Series Max. Cut-off Dia. ~ 16.0mm

### CTPA

Screw accessible from both sides

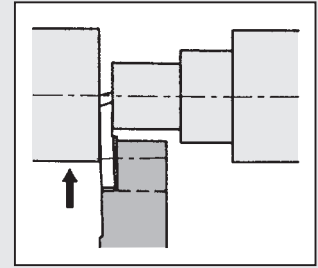
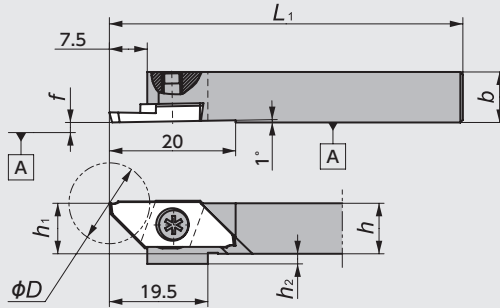

● Right-Hand style shown

Figure-1

### CTPA-OH2

□12 : CTPA $\frac{R}{L}$ 12H-OH2

□16 : CTPA $\frac{R}{L}$ 16X-OH2

(Coolant through)

Screw accessible from both sides

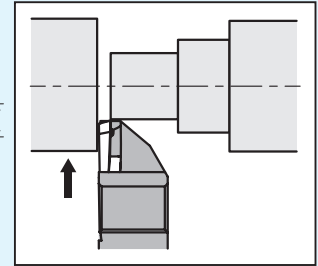
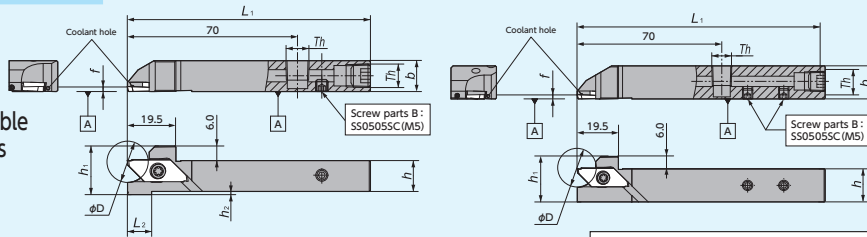

● Right-Hand style shown

Figure-2

● Left-Hand holders are designed for Right-Hand machines

Th (Screw parts A)  
1212/1616 size : SPR1/8(Rc1/8)

### CTPA-OH

(Coolant through)

Screw accessible from both sides

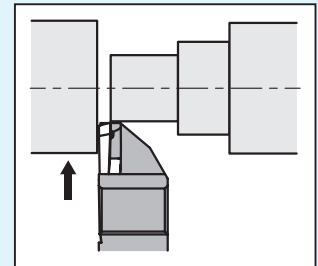
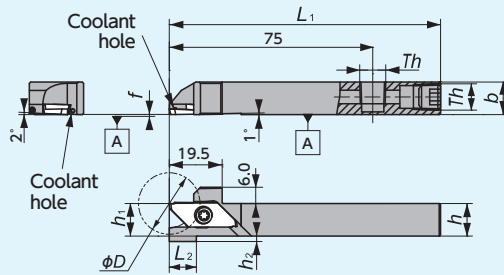

● Right-Hand style shown

Figure-3

● Left-Hand holders are designed for Right-Hand machines

Th  
□12, □16 : Rc1/8 (PT1/8)

### CTPAR-SUB

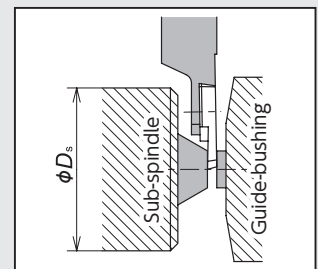
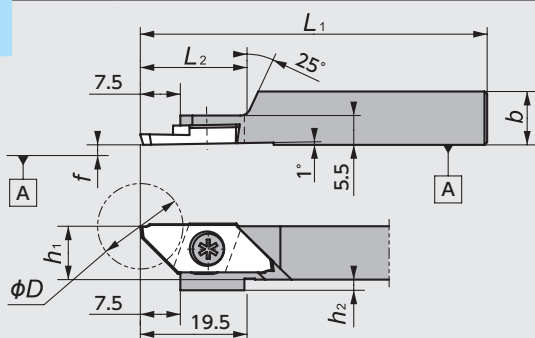

● Right-Hand style shown

Figure-4

$\phi D_s$   
CTPAR-SUB :  $\phi 36\text{mm}$

### CTPAL-SUB

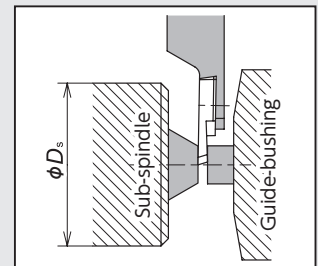
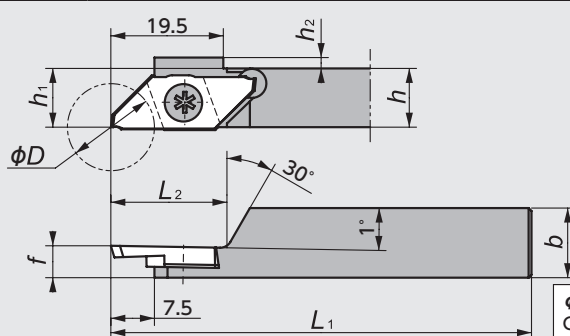

● Left-Hand style shown

Figure-5

$\phi D_s$   
CTPAL-SUB :  $\phi 36\text{mm}$

## CTPA Series - Toolholders

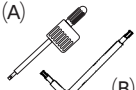
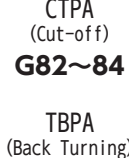
Figure	Code No.		Item Number	Stock		Max. Cut-off Dia (mm) $\phi D$	Dimensions (mm)							Gage insert 	Spare Parts		
	R	L		R	L		h	b	L <sub>1</sub>	h <sub>1</sub>	h <sub>2</sub>	L <sub>2</sub>	f		Clamp Screw		Wrench
															(A)	(B)	(A) 
1	5199187	5199153	CTPA $\frac{R}{L}$ 10	●	●	16.0 ※	10	10	120	10	2	—	0.0	 CTPA (Cut-off) <b>G82~84</b>  TBPA (Back Turning) <b>G55</b>	LRIS-4*10PW (A)	CLR-15S (A)	
	5016209	5016217	12GX	●	●		12	12	85	12	0				LRIS-4*12PW (A)		
	5199195	5199161	12	●	●		16	16	16	16	0				LRIS-4*10 (B)		LLR-25S (B)
	5199203	5199179	16	●	●		20	20	80	20							
	5459540	5459557	20F	●	●												
2	5037932	5037924	CTPA $\frac{R}{L}$ 12H-OH2	●	●	16.0 ※	12	12	100	12	2	10	2.0※	CTPA (Cut-off) <b>G82~84</b>	LRIS-4*12PW (A)	CLR-15S (A)	
	5043872	5043864	16X-OH2	●	●		16	16	120	16	0	0	2.0※				
3	5931522	5931530	CTPA $\frac{R}{L}$ 12H-OH	●	●	16.0 ※	12	12	100	12	2	10	2.0※	CTPA (Cut-off) <b>G82~84</b>	LRIS-4*12PW (A)	CLR-15S (A)	
	5931548	5931563	16H-OH	●	●		16	16		16	0	0	2.0※				
4	5600770		CTPAR10GX-SUB	●		16.0 ※	10	10	85	10	2	20	0.0	CTPA-FR (N)(V)(NV) <b>G82~84</b>	LRIS-4*5 (B)	LLR-25S (B)	
	5454681		12GX-SUB	●			12	12		12	0						
	5570676		12KX-SUB	●			120										
5		5505904	CTPAL10GX-SUB		●	16.0 ※	10	10	85	10	2	5.5	CTPA-FL (N)(K)(NV)(KV) <b>G82~84</b>	LRIS-4*5 (B)	LLR-25S (B)		
		5454699	12GX-SUB		●						20						
		5570684	12KX-SUB		●		12	12		12	0						
		5604871	16GX-SUB		●		16	16		85	16					28	
		5981659	16KX-SUB		●		120										

※ Would be changed by insert.