

CTP Series - Toolholders

Max. Cut-off Dia. - $\phi .472"$ (12.0mm)

CTP

Screw Accessible from both sides

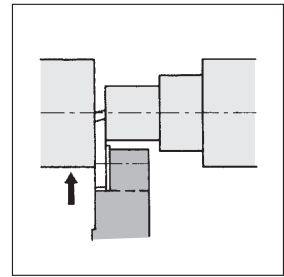
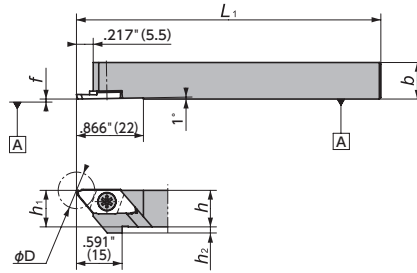

Right-Hand style shown

Figure-1

CTP-OH2 (Coolant through)

Screw Accessible from both sides

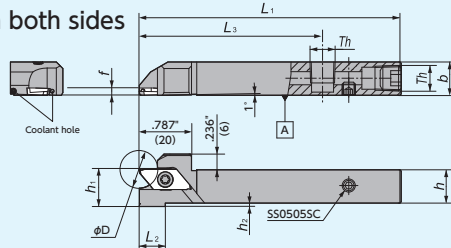

Th (Thread type)
 3/8" holder : M6 x 1
 1/2", 5/8" holder : NPT1/8
 Metric size holder: Rc1/8 (PT1/8)

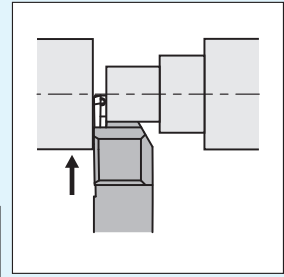

Right-Hand style shown

Figure-2 • Left-Hand holders are designed for Right-Hand machines

CTP-OH (Coolant through)

Screw Accessible from both sides

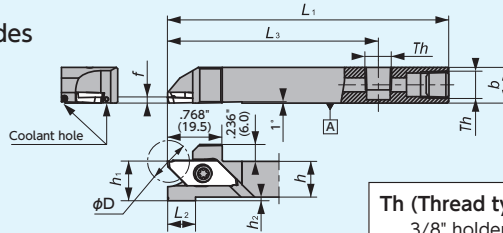

Th (Thread type)
 3/8" holder : M6 x 1
 1/2", 5/8" holder : NPT1/8
 Metric size holder: Rc1/8 (PT1/8)

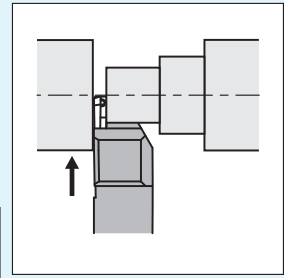

Right-Hand style shown

Figure-3 • Left-Hand holders are designed for Right-Hand machines

CTPR-SUB

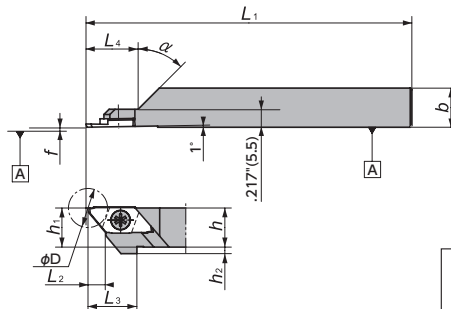

ϕD_s
 CTPR-SUB: $\phi 1.18"$ ($\phi 30$ mm)

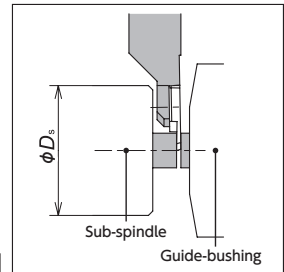
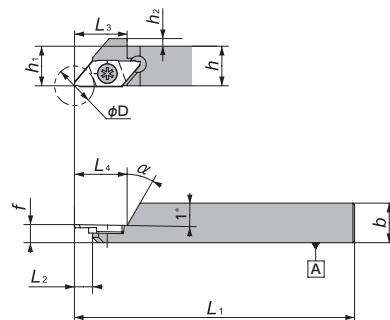

Figure-4

CTPL-SUB



ϕD_s
 CTPL-SUB: $\phi 1.18"$ ($\phi 30$ mm)

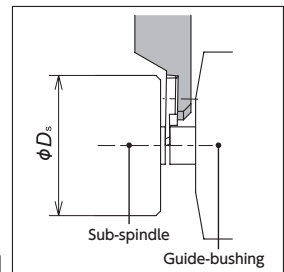



Figure-5

CTP

Gage Insert	Item Number	Figure	Stock		Max. Cut-off Dia. ϕD^*		h	h_1	b	L_1	h_2	L_2	L_3	Th	f		Clamp Screw	Wrench
			R	L	(Inch)	(mm)	(Inch)	(mm)	(Inch)	(mm)	(Inch)	(mm)	(Inch)		(mm)	(Inch)		
 CTP FR./FL..	CTP%06-IN	1	●	●	.472	12	3/8	3/8	3/8	4.724 120	.079 2	—	—	—	0.0	0.0	LRIS-4×10PW	CLR-15S
	CTP%08-IN	1	●	●	.472	12	1/2	1/2	1/2	4.724 120	0 0	—	—	—	0.0	0.0	LRIS-4×12PW	CLR-15S
	CTP%10-IN	1	●	●	.472	12	5/8	5/8	5/8	4.724 120	0 0	—	—	—	0.0	0.0	LRIS-4×12PW	CLR-15S
	CTP%08	1	●	●	.472	12	.315 8	.315 8	.394 10	4.724 120	.157 4	—	—	—	0.0	0.0	LRIS-4×10PW	CLR-15S
	CTP%10H	1	○	○	.472	12	.394 10	.394 10	.394 10	3.937 100	.079 2	—	—	—	0.0	0.0	LRIS-4×10PW	CLR-15S
	CTP%10	1	○	○	.472	12	.394 10	.394 10	.394 10	4.724 120	.079 2	—	—	—	0.0	0.0	LRIS-4×10PW	CLR-15S
	CTP%12GX	1	○	○	.472	12	.472 12	.472 12	.472 12	3.346 85	0 0	—	—	—	0.0	0.0	LRIS-4×12PW	CLR-15S
	CTP%12	1	○	○	.472	12	.472 12	.472 12	.472 12	4.724 120	0 0	—	—	—	0.0	0.0	LRIS-4×12PW	CLR-15S
	CTP%13	1	○	○	.472	12	.519 13	.519 13	.519 13	4.724 120	0 0	—	—	—	0.0	0.0	LRIS-4×12PW	CLR-15S
	CTP%16H	1	○	○	.472	12	.630 16	.630 16	.630 16	3.937 100	0 0	—	—	—	0.0	0.0	LRIS-4×12PW	CLR-15S
	CTP%16	1	○	○	.472	12	.630 16	.630 16	.630 16	4.724 120	0 0	—	—	—	0.0	0.0	LRIS-4×12PW	CLR-15S
	CTP%06H-IN-OH	3	●	●	.472	12	3/8	.472 12	3/8	3.937 100	.176 4.475	.748 19	2.953 75	M6 × 1	0.0	0.0	LRIS-4×10PW	CLR-15S
	CTP%08H-IN-OH	3	■	■	.472	12	1/2	1/2	1/2	3.937 100	.051 1.3	.394 10	2.953 75	NPT1/8	0.0	0.0	LRIS-4×12PW	CLR-15S
	CTP%08H-IN-OH2	2	●	●	.472	12	1/2	1/2	1/2	3.937 100	.051 1.3	.394 10	2.756 70	NPT1/8	0.0	0.0	LRIS-4×12PW	CLR-15S
	CTP%1012H-OH	3	○	○	.472	12	.394 10	.472 12	.394 10	3.937 100	.176 4.475	.748 19	2.953 75	M6 × 1	0.0	0.0	LRIS-4×12PW	CLR-15S
	CTP%12H-OH	3	■	■	.472	12	.472 12	.472 12	.472 12	3.937 100	.051 1.3	.394 10	2.953 75	Rc1/8(PT1/8)	0.0	0.0	LRIS-4×12PW	CLR-15S
	CTP%12H-OH2	2	●	●	.472	12	.472 12	.472 12	.472 12	3.937 100	.051 1.3	.394 10	2.756 70	Rc1/8(PT1/8)	0.0	0.0	LRIS-4×12PW	CLR-15S
CTP%16H-OH	3	○	○	.472	12	.630 16	.630 16	.630 16	3.937 100	0 0	—	2.953 75	Rc1/8(PT1/8)	0.0	0.0	LRIS-4×12PW	CLR-15S	

● Left-Hand coolant through holders are designed for Right-Hand machines

* Would be changed by insert

CTPR-SUB

Gage Insert	Item Number	Figure	Stock		Max. Cut-off Dia. ϕD^*		h	h_1	b	L_1	h_2	L_2	L_3	L_4	α	f		Clamp Screw	Wrench
			R	L	(Inch)	(mm)	(Inch)	(mm)	(Inch)	(mm)	(Inch)	(mm)	(Inch)	(mm)		(Inch)	(mm)		
 CTPR..FR..	CTPR06-IN-SUB	4	●	●	.472	12	3/8	3/8	3/8	4.724 120	.079 2	.217 5.5	.591 15	.630 16	45°	.217 5.5	LRIS-4×5	LLR-25S	
	CTPR08-IN-SUB	4	●	●	.472	12	1/2	1/2	1/2	4.724 120	0 0	.217 5.5	.591 15	.630 16	45°	.217 5.5	LRIS-4×5	LLR-25S	
	CTPR10-IN-SUB	4	●	●	.472	12	5/8	5/8	5/8	4.724 120	0 0	.217 5.5	.591 15	.630 16	45°	.217 5.5	LRIS-4×5	LLR-25S	
	CTPR08-SUB	4	○	○	.472	12	.315 8	.315 8	.315 8	4.724 120	.157 4	.217 5.5	.591 15	.630 16	45°	.217 5.5	LRIS-4×5	LLR-25S	
	CTPR08J-SUB	4	○	○	.472	12	.315 8	.315 8	.315 8	4.331 110	.157 4	.217 5.5	.591 15	.630 16	45°	.217 5.5	LRIS-4×5	LLR-25S	
	CTPR10F-SUB	4	○	○	.472	12	.394 10	.394 10	.394 10	3.150 80	.079 2	.217 5.5	.591 15	.630 16	45°	.217 5.5	LRIS-4×5	LLR-25S	
	CTPR10KX-SUB	4	○	○	.472	12	.394 10	.394 10	.394 10	4.724 120	.079 2	.217 5.5	.591 15	.630 16	45°	.217 5.5	LRIS-4×5	LLR-25S	
	CTPR12GX-SUB	4	○	○	.472	12	.472 12	.472 12	.472 12	3.346 85	0 0	.217 5.5	.591 15	.630 16	45°	.217 5.5	LRIS-4×5	LLR-25S	
	CTPR12-SUB	4	○	○	.472	12	.472 12	.472 12	.472 12	4.724 120	0 0	.217 5.5	.591 15	.630 16	45°	.217 5.5	LRIS-4×5	LLR-25S	

* Would be changed by insert

CTPL-SUB

Gage Insert	Item number	Figure	Stock		Max. Cut-off Dia. ϕD^*		h	h_1	b	L_1	h_2	L_2	L_3	L_4	α	f		Clamp screw	Wrench
			L	R	(Inch)	(mm)	(Inch)	(mm)	(Inch)	(mm)	(Inch)	(mm)	(Inch)	(mm)		(Inch)	(mm)		
 CTPL..FL..	CTPL08-SUB	5	○	○	.472	12	.315 8	.315 8	.394 10	4.724 120	.157 4	.217 5.5	.591 15	.630 16	30°	.217 5.5	LRIS-4×5	LLR-25S	
	CTPL08J-SUB	5	○	○	.472	12	.315 8	.315 8	.315 8	4.331 110	.157 4	.217 5.5	.591 15	.630 16	30°	.217 5.5	LRIS-4×5	LLR-25S	
	CTPL10GX-SUB	5	○	○	.472	12	.394 10	.394 10	.394 10	3.346 85	.079 2	.217 5.5	.591 15	.630 16	30°	.217 5.5	LRIS-4×5	LLR-25S	
	CTPL12GX-SUB	5	○	○	.472	12	.472 12	.472 12	.472 12	3.346 85	0 0	.217 5.5	.591 15	.630 16	30°	.217 5.5	LRIS-4×5	LLR-25S	

* Would be changed by insert

Cutting condition **→S5**

Inserts (Right-hand) **→S10** Inserts (Left-hand) **→S11**

● : Stock
 ● : Stock (Newly added)
 ■ : While stocks last
 R L : Stock (Right / Left-hand only)
 R L : Stock (Right / Left-hand only, Newly added)
 ○ : 1-2 week delivery
 ○ : 1-2 week delivery (Newly added)
 ⊕ : Mirror finish
 ⊕ : 1-2 week delivery (Right / Left-hand only)
 ⊕ : 1-2 week delivery (Right / Left-hand only, Newly added)
 ⊕ : Coolant through

Cut-off

CTP Series Inserts (Right-Hand)

Two-sided insert

Max. Cut-off Dia. - ϕ .472"(12.0mm)

■ CTP / CTPX / CTP-X

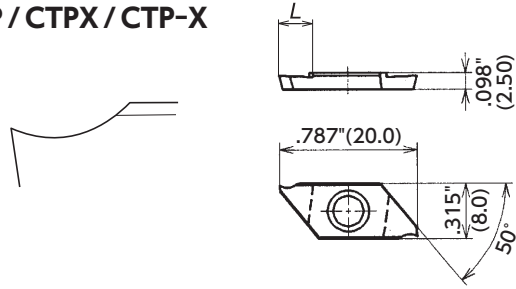

CX-Chipbreaker

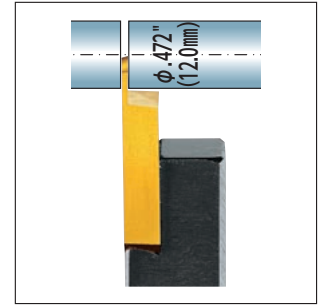

Right-Hand style shown

All angles shown are obtained when insert is set in the holder.

■ FR

Shape	Item Number	Figure	Chip-breaker	Max. Cut-off Dia. ϕD		w		L		θ	$r_{\epsilon 1}$	Coated Carbide						Carbide	PCD			
				(Inch)	(mm)	(Inch)	(mm)	(Inch)	(mm)			ST4	DM4	DT4	QM3	VM1	ZM3			KM1	PD1	
Figure-1	CTP05FR-SH	1	Yes	.197	5.0	.020	0.5	.110	2.8	15°	.001	0.03										
	CTP07FR	1	Yes	.315	8.0	.028	0.7	.177	4.5	16°	.002	0.05										
Figure-2	CTP10FR-SH	1	Yes	.275	7.0	.039	1.0	.161	4.1	15°	.002	0.05			○							
	CTP10FR	1	Yes	.472	12.0	.039	1.0	.264	6.7	16°	.002	0.05			●		●					
Figure-3	CTP10FR-CX	2	Yes-CX	.472	12.0	.039	1.0	.264	6.7	16°	.002	0.05	●	●								
	CTP10FR-TH	1	Yes	.472	12.0	.039	1.0	.264	6.7	16°	.002	0.05	●									
Figure-4	CTP10FRFT	4	No	.472	12.0	.039	1.0	.264	6.7	16°	.002	0.05	●			●						
	CTP10FRV	3	No	.472	12.0	.039	1.0	.264	6.7	20°	0.0	0.0			○		●		●			
Figure-1	CTP13FR-CX	2	Yes-CX	.472	12.0	.051	1.3	.264	6.7	16°	.002	0.05	●	●								
	CTP15FR	1	Yes	.472	12.0	.059	1.5	.264	6.7	16°	.002	0.05					●		●			
Figure-2	CTPX15FR	1	Yes	.472	12.0	.059	1.5	.264	6.7	16°	.002	0.05				●		●				
	CTP15FRX	1	Yes	.472	12.0	.059	1.5	.264	6.7	16°	.002	0.05							○			
Figure-3	CTP15FR-CX	2	Yes-CX	.472	12.0	.059	1.5	.264	6.7	16°	.002	0.05	●	●								
	CTP15FR-TH	1	Yes	.472	12.0	.059	1.5	.264	6.7	16°	.002	0.05	●									
Figure-4	CTP15FRV	3	No	.472	12.0	.059	1.5	.264	6.7	20°	0.0	0.0					●		●		●	
	CTP20FR	1	Yes	.472	12.0	.079	2.0	.264	6.7	16°	.002	0.05					●		●			
Figure-1	CTP20FR	1	Yes	.472	12.0	.079	2.0	.264	6.7	16°	.002	0.05				●		●		○		
	CTP20FRX	1	Yes	.472	12.0	.079	2.0	.264	6.7	16°	.002	0.05								○		
Figure-2	CTP20FR-TH	1	Yes	.472	12.0	.079	2.0	.264	6.7	16°	.002	0.05	●									
	CTP20FRV	3	No	.472	12.0	.079	2.0	.264	6.7	20°	0.0	0.0					●		●		●	

■ FRN

Shape	Item Number	Figure	Chip-breaker	Max. Cut-off Dia. ϕD		w		L		θ	$r_{\epsilon 1}$	Coated Carbide						Carbide	PCD				
				(Inch)	(mm)	(Inch)	(mm)	(Inch)	(mm)			ST4	DM4	DT4	QM3	VM1	ZM3			KM1	PD1		
Figure-1	CTP05FRN-SH	1	Yes	.197	5.0	.020	0.5	.110	2.8	0°	.001	0.03											
	CTP10FRN-SH	1	Yes	.275	7.0	.039	1.0	.161	4.1	0°	.002	0.05				○							
Figure-2	CTP10FRN	1	Yes	.472	12.0	.039	1.0	.264	6.7	0°	.002	0.05											
	CTP10FRN-CX	2	Yes-CX	.472	12.0	.039	1.0	.264	6.7	0°	.002	0.05	●	●									
Figure-3	CTP10FRN-TH	1	Yes	.472	12.0	.039	1.0	.264	6.7	0°	.002	0.05	●										
	CTP13FRN02-CX	2	Yes-CX	.472	12.0	.051	1.3	.264	6.7	0°	.002	0.05	●	●									
Figure-1	CTP15FRN-CX	2	Yes-CX	.472	12.0	.059	1.5	.264	6.7	0°	.002	0.05	●	●									
	CTP15FRN02-CX	2	Yes-CX	.472	12.0	.059	1.5	.264	6.7	0°	.008	0.2	●	●									
Figure-2	CTP15FRN	1	Yes	.472	12.0	.059	1.5	.264	6.7	0°	.002	0.05					●		●				
	CTPX15FRN	1	Yes	.472	12.0	.059	1.5	.264	6.7	0°	.002	0.05				●		●					
Figure-3	CTP15FRNX	1	Yes	.472	12.0	.059	1.5	.264	6.7	0°	.002	0.05								○			
	CTP15FRN-TH	1	Yes	.472	12.0	.059	1.5	.264	6.7	0°	.002	0.05	●										
Figure-4	CTP15FRNV	3	No	.472	12.0	.059	1.5	.264	6.7	0°	0.0	0.0										●	
	CTP20FRN	1	Yes	.472	12.0	.079	2.0	.264	6.7	0°	.002	0.05					●		●				
Figure-1	CTPX20FRN	1	Yes	.472	12.0	.079	2.0	.264	6.7	0°	.002	0.05					●		●				
	CTP20FRNX	1	Yes	.472	12.0	.079	2.0	.264	6.7	0°	.002	0.05								○			
Figure-2	CTP20FRN-TH	1	Yes	.472	12.0	.079	2.0	.264	6.7	0°	.002	0.05	●										
	CTP20FRNV	3	No	.472	12.0	.079	2.0	.264	6.7	0°	0.0	0.0										●	

■ FRK

Shape	Item Number	Figure	Chip-breaker	Max. Cut-off Dia. ϕD		w		L		θ	$r_{\epsilon 1}$	Coated Carbide						Carbide	PCD				
				(Inch)	(mm)	(Inch)	(mm)	(Inch)	(mm)			ST4	DT4	QM3	VM1	ZM3	KM1			PD1			
Figure-1	CTP10FRK	1	Yes	.433	11.0	.039	1.0	.264	6.7	16°	.002	0.05											
	CTP15FRK	1	Yes	.433	11.0	.059	1.5	.264	6.7	16°	.002	0.05										○	
	CTP20FRK	1	Yes	.433	11.0	.079	2.0	.264	6.7	16°	.002	0.05										○	

Cut-off

CTP Series Inserts (Left-Hand)

Two-sided insert

Max. Cut-off Dia. - ϕ .472"(12.0mm)

■ CTP / CTPX / CTP-X

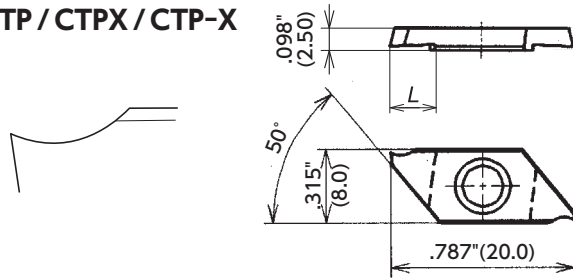

CX-Chipbreaker
(Right-hand shown)

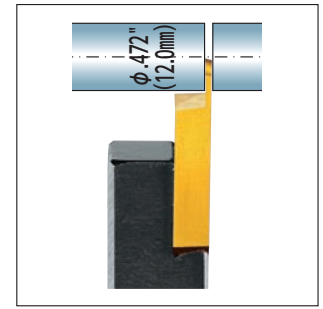

Left-Hand style shown

All angles shown are obtained when insert is set in the holder.

■ FLK

Shape	Item Number	Figure	Chip-breaker	Max. Cut-off Dia. ϕD		w		L		θ	$r_{\epsilon 1}$		Coated Carbide					Carbide	PCD
				(Inch)	(mm)	(Inch)	(mm)	(Inch)	(mm)		(Inch)	(mm)	ST4	DM4	DT4	QM3	VM1	ZM3	KM1
Figure-1	CTP05FLK-SH	1	Yes	.197	5.0	.020	0.5	.110	2.8	17°	.001	0.03						●	
	CTP10FLK-SH	1	Yes	.275	7.0	.039	1.0	.161	4.1	17°	.002	0.05			○			○	
	CTP10FLK	1	Yes	.433	11.0	.039	1.0	.264	6.7	16°	.002	0.05			●			●	
Figure-2	CTP10FLK-CX	2	Yes-CX	.433	11.0	.039	1.0	.264	6.7	16°	.002	0.05	●	●					
	CTP10FLK-TH	1	Yes	.433	11.0	.039	1.0	.264	6.7	16°	.002	0.05	●						
	CTP10FLK-211	1	Yes	.472	12.0	.039	1.0	.295	7.5	16°	.002	0.05					●		
Figure-3 Flat top	CTP13FLK-CX	2	Yes-CX	.472	12.0	.051	1.3	.264	6.7	16°	.002	0.05	●	●					
	CTP15FLK	1	Yes	.433	11.0	.059	1.5	.264	6.7	16°	.002	0.05					○	●	
	CTP15FLKB	1	Yes	.433	11.0	.059	1.5	.264	6.7	16°	.002	0.05					○	○	
	CTPX15FLK	1	Yes	.433	11.0	.059	1.5	.264	6.7	16°	.002	0.05							
	CTP15FLK-CX	2	Yes-CX	.433	11.0	.059	1.5	.264	6.7	16°	.002	0.05	●	●					
	CTP15FLK-TH	1	Yes	.433	11.0	.059	1.5	.264	6.7	16°	.002	0.05	●						
	CTP15FLKV	3	No	.433	11.0	.059	1.5	.264	6.7	20°	0.0	0.0					●	●	
CTP20FLK	1	Yes	.433	11.0	.079	2.0	.264	6.7	16°	.002	0.05					○	●		
CTPX20FLK	1	Yes	.433	11.0	.079	2.0	.264	6.7	16°	.002	0.05								
CTP20FLK-TH	1	Yes	.433	11.0	.079	2.0	.264	6.7	16°	.002	0.05	●							

■ FLN

Shape	Item Number	Figure	Chip-breaker	Max. Cut-off Dia. ϕD		w		L		θ	$r_{\epsilon 1}$		Coated Carbide					Carbide	PCD
				(Inch)	(mm)	(Inch)	(mm)	(Inch)	(mm)		(Inch)	(mm)	ST4	DM4	DT4	QM3	VM1	ZM3	KM1
Figure-1	CTP05FLN-SH	1	Yes	.197	5.0	.020	0.5	.110	2.8	0°	.001	0.03						●	
	CTP10FLN-SH	1	Yes	.275	7.0	.039	1.0	.161	4.1	0°	.002	0.05			○			○	
	CTP10FLN	1	Yes	.472	12.0	.039	1.0	.264	6.7	0°	.002	0.05			●			●	
Figure-2	CTP10FLN-CX	2	Yes-CX	.472	12.0	.039	1.0	.264	6.7	0°	.002	0.05	●	●					
	CTP10FLN-TH	1	Yes	.472	12.0	.039	1.0	.264	6.7	0°	.002	0.05	●						
	CTP13FLN-CX	2	Yes-CX	.472	12.0	.051	1.3	.264	6.7	0°	.002	0.05	●	●					
Figure-3 Flat top	CTP13FLN02-CX	2	Yes-CX	.472	12.0	.051	1.3	.264	6.7	0°	.008	0.2	●	●					
	CTP15FLN-CX	2	Yes-CX	.472	12.0	.059	1.5	.264	6.7	0°	.002	0.05	●	●					
	CTP15FLN02-CX	2	Yes-CX	.472	12.0	.059	1.5	.264	6.7	0°	.008	0.2	●	●					
	CTP15FLN	1	Yes	.472	12.0	.059	1.5	.264	6.7	0°	.002	0.05					○	●	
	CTPX15FLN	1	Yes	.472	12.0	.059	1.5	.264	6.7	0°	.002	0.05							
	CTP15FLN-TH	1	Yes	.472	12.0	.059	1.5	.264	6.7	0°	.002	0.05	●						
	CTP15FLNV	3	No	.472	12.0	.059	1.5	.264	6.7	0°	0.0	0.0						●	
CTP20FLN	1	Yes	.472	12.0	.079	2.0	.264	6.7	0°	.002	0.05					○	●		
CTPX20FLN	1	Yes	.472	12.0	.079	2.0	.264	6.7	0°	.002	0.05								
CTP20FLN-TH	1	Yes	.472	12.0	.079	2.0	.264	6.7	0°	.002	0.05	●							
CTP20FLNV	3	No	.472	12.0	.079	2.0	.264	6.7	0°	0.0	0.0							●	

■ FL

Shape	Item Number	Figure	Chip-breaker	Max. Cut-off Dia. ϕD		w		L		θ	$r_{\epsilon 1}$		Coated Carbide					Carbide	PCD
				(Inch)	(mm)	(Inch)	(mm)	(Inch)	(mm)		(Inch)	(mm)	ST4	DT4	QM3	VM1	ZM3	KM1	PD1
Figure-1	CTP07FL	1	Yes	.315	8.0	.028	0.7	.177	4.5	16°	.002	0.05						●	
	CTP10FL	1	Yes	.472	12.0	.039	1.0	.264	6.7	16°	.002	0.05						○	
	CTP10FLV	2	No	.472	12.0	.039	1.0	.264	6.7	20°	0.0	0.0						○	
Figure-2 Flat top	CTP15FL	1	Yes	.472	12.0	.059	1.5	.264	6.7	16°	.002	0.05						○	
	CTPX15FL	1	Yes	.472	12.0	.059	1.5	.264	6.7	16°	.002	0.05							
	CTP15FLV	2	No	.472	12.0	.059	1.5	.264	6.7	20°	0.0	0.0						○	
	CTP20FL	1	Yes	.472	12.0	.079	2.0	.264	6.7	16°	.002	0.05						○	●
	CTPX20FL	1	Yes	.472	12.0	.079	2.0	.264	6.7	16°	.002	0.05							
CTP20FLV	2	No	.472	12.0	.079	2.0	.264	6.7	20°	0.0	0.0						○	○	

Holders →S8 Tool selection guide →S4 Cutting Condition →S5

● : Stock
 ● : Stock (Newly added)
 ■ □ □ □ : While stocks last
 R L : Stock (Right / Left-hand only)
 R L : Stock (Right / Left-hand only, Newly added)
 ○ : 1-2 week delivery
 ○ : 1-2 week delivery (Newly added)
 ● : Coolant through
 (R) : 1-2 week delivery (Right / Left-hand only)
 (R) : 1-2 week delivery (Right / Left-hand only, Newly added)

Cut-off